

Antelope Valley Community College District

2017-2021 Five Year Construction Plan (2017-2018 First Funding Year)

July 2015



Facilities Planning and Consulting Services
Exeter, California

2017-21 FIVE YEAR CAPITAL OUTLAY PLAN
(2017-18 FIRST FUNDING YEAR)

Antelope Valley CCD

Prepared in reference to the Community College Construction Act of 1980
and
approved on behalf of the local governing board for submission to
the office of the Chancellor, California Community Colleges

Signed _____

Mr. Ed Knudson
(Chief Executive Officer
or their designee)

Title _____ Superintendent/President _____

Date _____

Contact Person Doug Jensen _____

Telephone (661) 722-6302 _____

Date Received at
Chancellor's Office

Chancellor's Office
reviewed by

Notice of Approval

EXECUTIVE SUMMARY

ANTELOPE VALLEY COMMUNITY COLLEGE DISTRICT

Antelope Valley Community College District presently consists of Antelope Valley College, an attractive well-planned 135 acre campus in Lancaster and the Palmdale Center located in a leased facility in Palmdale.

Antelope Valley Community College District's service area is part of what economist John Husing calls the "Third Ring of Economic Development" from the Los Angeles Basin. The ring extends across the Lancaster/Palmdale, Victorville, Ontario/San Bernardino, Riverside and I-15 corridor area. As a result, this is one of the fastest growing areas in California. For example, between 1990 and 2000 the population of Lancaster grew to 118,718, a 22 percent increase and Palmdale grew to 116,670, a 69.5 percent increase. These compare with a 7.1 percent growth for Burbank, 8.3 percent for Glendale, 6.0 percent for Los Angeles, 1.8 percent for Pasadena and 36.6 percent for Santa Clarita. In 2005 the cities of Lancaster and Palmdale were the first and second fastest growing cities in Los Angeles County.

Population Projections

The Southern California Association of Governments (SCAG) has forecast that the population of the Antelope Valley College service area will continue to grow rapidly, reaching 559,519 during the ten years from 2010-2020. The driving force behind this rapid population growth is "cheap dirt"; affordable land for residential property and low cost land for small businesses. As property values appreciate in the Los Angeles basin, people and small business enterprises will relocate to where they can find "cheap dirt", the Lancaster/Palmdale Area. This movement has intensified as the local economy has expanded during the past twenty-five years.

The population served by Antelope Valley College has become increasingly younger and more diverse. For example, the 2000 census found the composition of the population to include:

<i>Ethnicity</i>	<i>Percentage</i>
African American	15 percent
Asian	4 percent
Hispanic	31 percent
White	48 percent
Other	<u>2 percent</u>
Total	100 percent

The Antelope Valley College service area adult population is only 66.6 percent of the total population. This compares with the 74.5 percent for the state of California as a whole and 75.7 for the nation. Out of a population of 370,430 for 2000, 243,372 were adults. For planning purposes, this means Antelope Valley College must anticipate a greater flow of students from its feeder high schools in the future years as the sub – 18 year olds progress through the system. This is clearly reflected in the high school graduation increase of 8.98 percent for 2004-05 and 12.24 percent for the 2005-06 from the Antelope Valley high schools (see Addendum A, State General Apportionment Calculations).

SCAG is projecting an increase in the Antelope Valley College service area population of 187,115 persons from 2000 to 2010, an annual increase of 18,712. By the year 2010, the service area is projected to have in excess of 540,000 people (see Table 2, page 3).

SCAG is also projecting by the year 2020 some 760,020 people will live in the Antelope Valley College service area. This is a phenomenal doubling of the population in only 20 years. As is demonstrated in Table 3, the most rapid population increase will occur in the unincorporated areas of the Antelope Valley College service area, a 54.82 percent increase by the year 2015 and 102.15 percent increase by 2025 (See Addenda B-D).

Increasing Enrollments

For the decade of the 1990's, Antelope Valley College increased from 84,118 to 106,586 weekly student contact hours (WSCH), a 26.7 increase. It must be noted that the 90's included four years when colleges were not funded for growth.

The student population being served is fairly typical for a California community college:

Women	58.8 percent
Average Age	27 years of age
Day Enrollment	76.2 percent
Under-represented Students	45.3 percent
Other	29.9 percent

Some 61.4 percent of students are under 24 years of age.

Growth Funding and Facility Forecasting

Antelope Valley has a blended growth rate funded level of 2.76 percent for 2004-05 and 7.97 percent for 2005-06. This was based on a 1.88 percent adult population change and a 3.59 percent increase in the high school graduation rate for 2004-05 and a 3.17 percent increase in the adult population and a 12.24 percent change in the high school graduation rate for 2005-06. There is nothing to support a decrease in the high school graduation rate for the Antelope Valley service area, and the greater area is experiencing a population expansion as people come up the I-5 and I-14 corridors seeking affordable housing.

Economic Development

The economy of the Antelope Valley Community College District service area during the past twenty years has been driven largely by the need for low-cost land by homeowners and small businesses - the first phase of the Third Ring of Economic Development from Los Angeles. This trend has resulted in a large work commuter population, nearly 45% of the Antelope Valley workforce. This trend will continue for the foreseeable future: high population and small business growth. This trend is especially noticeable with the current redevelopment effort in downtown Lancaster. Eventually, larger employers will follow to locate close to their workers and reduce their operating cost (see Addendum E).

The economy is driven by retail businesses and service jobs; construction, finance, insurance and real estate; a strong military/industrial sector; small company manufacturing and transportation/utilities. The Antelope Valley economy is now in the stage for industrial growth and an increase in blue-collar jobs.

Antelope Valley Community College District is an integral component of the planning and development of the economy. It also contributes to the economic development of the high desert by cooperating with California State University Bakersfield in making upper division and graduate programs available on the Antelope Valley College campus.

Mission

The mission of Antelope Valley College is to serve the community by providing comprehensive programs in the following areas:

- Transfer Education
- Vocational and Technical Education
- Workforce Preparation and Economic Development
- Personal Enrichment and Professional Development
- Student Services
- Transitional Education

Values

Antelope Valley College is a community of caring people who foster positive human values both in the learning environment and their work.

- Student-Centered Learning
- Student Services
- Accessible Quality Program
- Individuality and Diversity

Growth patterns for each discipline and service were assessed relative to campus-wide growth, the local economy and trends in technology. Goals, objectives, and needs were identified through this process.

Facilities Master Plan

A comprehensive revision of the Antelope Valley College Facilities Master Plan was completed in 2003. An update to the Facilities Master Plan was completed in 2010 based on the recently updated Educational Master Plan. Projects in the Five-Year Construction Plan are a direct out-growth of the Educational and Facilities Master Plans. The Facilities Master Plan identifies facilities, fields and parking that will be needed to serve the rapidly increasing population of the Antelope Valley services area for the coming twenty years. Planning is continuing for a campus to serve the southeastern portion of the District (Palmdale Campus). In preparation for this new campus planning is in process to complete required engineering studies, EIR/CEQA study, campus master plan, city coordination activities, local funding plan and project final project proposal. The facilities listed as construction priorities are a reflection of the Antelope Valley College Facilities Master Plan and new Palmdale Campus plan.

General Bond Election

In November 2004, the District offered a general obligation bond, Measure R, to voters of its services area. The voters responded overwhelmingly in favor of the bond approving the \$139,000,000 measure with a 68% approval rate. The bond funds will be used for an assortment of much needed campus projects which the state does not fund and for matching state construction funds for needed building projects to modernize 60 year old facilities and infrastructure and to construct new buildings needed for the doubling of its service area population by 2020.

Antelope Valley College Campus

Antelope Valley College was founded in 1929 and relocated from the Antelope Valley Union High School District campus in downtown Lancaster to its present location in 1960. The campus is located in a picturesque suburban setting on the west side of State Highway 14 in Lancaster. The first buildings were completed in 1960 to accommodate 1,500 students. Each decade new facilities have been added to the 135 acre campus. A local building boom in the 1980's spurred a large expansion of the campus in the early 1990's and the passage of Measure R initiated the largest construction phase in the colleges' history resulting in nearly \$200,000,000 in construction activity. Main objectives for the Districts latest construction phase included developing infrastructure capacity for expansion of the campus during the next thirty years and to implement energy efficiency measures campus wide. As Antelope Valley College approaches the 20,000 student threshold the campus is primed to expand facilities in a responsive and efficient manner.

Palmdale Campus

Population forecasts demonstrate that a second campus will soon be needed to serve the greater Palmdale portion of the Antelope Valley College service area. The three major components of the Antelope Valley Community College District are all among the fastest population growth areas in the state of California: Lancaster, Palmdale, and the unincorporated area. An April 2004 population study by SCAG forecast a population for the Antelope Valley College service area of 854,098 by the year 2025 – an increase from 444,709 for 2005, or a 92.05 percent increase in only 20 years. This population would outgrow the Lancaster Campus, e.g.: 854,098 population x 68 percent Adult Population = 580,787 adults x 6 percent Student Enrollment Rate = 34,847 students. The Lancaster Campus is planned for a 25,000 student population – another campus is imperative.

For 2005, SCAG estimated the population of the incorporated city of Palmdale at 145,995 and forecasts a population of 218,387 by 2015 and 299,324 by 2025, a 105 percent increase in only 20 years. This means a potential 2015 enrollment of 8,910 is probable (218,387 x 68 percent Adult Population x 6 percent Student Enrollment Rate) from the incorporated Palmdale area. The remainder of the

District has a probable enrollment of 17,726 for 2015 (Lancaster and Unincorporated area): 434,473 population x 68 percent Adult Population x 6 percent Student Enrollment Rate = 17,726 students. By the year 2025, the Palmdale Campus would have some 12,212 students (299,324 x 68 percent Adult Population x 6 percent Student Enrollment Rate) and the Lancaster Campus would have some 22,632 students (554,774 x percent Adult Population x 6 percent Enrollment Rate). Title to the Palmdale Campus was obtained in 2007 allowing this important project to proceed forward.

It is imperative that the Palmdale Campus be approved for the 2013/14 funding – the students are already there with enrollment over 1,500 FTES in the 2010-11 year.

FIVE-YEAR CONSTRUCTION PLAN PROJECTS

District Priority #1 – Theater Arts Facility (Shared Funding)

This project includes a full-service Theatre Facility with seating for 400 students to hone their skills. The facility includes a lobby area, coatroom, ticket room, manager's office, orchestra pit, scene shop, prop storage room, green room, dressing rooms, meeting rooms, offices and storage. An FPP has been submitted for 2006-07 shared funding. A Room/Space Use Analysis for 2002 found that the District generated 1,900 Dramatic Arts WSCH, yet did not have single lecture classroom or laboratory dedicated to dramatic arts. The District has updated its Master Plan for the Dramatic Arts program to offer a continuing comprehensive array of degree and certificate programs (See Appendix E.). Facility was occupied in 2011.

District Priority #2 – Health & Science Building (Shared Funding)

This major project is a major multi-story building to house the life and physical sciences, and the Health Science Division programs. The present science buildings on the Lancaster Campus are nearly 50 years old with inadequate wiring for computer/electronic technology. These buildings also present construction safety concerns that would be excessively expensive to reconstruct. Facility was occupied in 2012.

District Priority #3 – Teaching and Learning Center (State Funding)

This project would expand the services of the Learning Center program and incorporate mathematics, engineering, ESL and reading programs into one facility providing synergistic learning environment. Expanded open computer labs, study centers, tutoring and supplemental instruction areas will support the growing

student demand for these classes and services. *An FPP is being re- submitted for 2017-18 state funding.*

District Priority #4 – Gym Renovation & Expansion (State Funding)

This project is for renovation of the existing building structure and systems that were constructed in 1960, modernize the facility to meet current building and energy code requirements and provide additional instructional and support space. *An IPP is being submitted for 2018-19 state funding.*

District Priority #5 – Technical Building II (State Funding)

This project is for accommodating the relocation of existing programs to meet new technology requirements and occupancy demands as well as for new technical education programs. *An IPP is being submitted for 2018-19 state funding.*

District Priority #6 – Off/On Site Development and Initial Facilities (Shared Funding)

This project would provide initial on-site infrastructure and the initial permanent facility for the Palmdale Center. The initial facility will be comprised of instructional lab and lecture space, library space and office space to meet the defined programs for the new center. Local funding will be required to complete all parking areas, off-site infrastructure requirements, initial play fields, bookstore and dining requirements. *An IPP will be submitted for 2019-20 state funding.*

Other projects include:

- Student Services Building
- Human Performance Center
- Existing Student Services Replacement
- Arts Complex Replacement, Expansion
- Learning Center Modernization
- Student Center Replacement, Expansion (Local Funding)
- New Instructional Building
- Library Modernization
- Automotive Technology Complex – Phase III

Space Inventory

The Antelope Valley College Space Inventory is thoroughly reviewed each year and adjusted as needed to keep the inventory accurate.

District Energy Plan

Antelope Valley College, located in the high desert, must accommodate:

- A wide range of temperatures.
- Intense winds at times.
- Weather so beautiful at times that it encourages one to be outdoors.
- Some snow, some rain.

This climate makes everyone on campus sensitive to energy issues – students, faculty, staff and administrators alike.

The need to conserve high cost energy has prompted the College to take the following steps during the past ten years:

- Completed a one megawatt photovoltaic system in 2011 to provide the Lancaster campus with a more affordable and green source of electricity.
- Completed energy efficiency project in 2010 that included campus wide interior lighting retrofit, exterior lighting retrofit, central plant efficiency redesign, energy management building controls, computer power management, computer server efficiency upgrade, variable speed pool pump and irrigation system controls upgrade. Installation of new variable speed chillers, pumps and ‘dolphin’ water treatment system was also completed at the newly constructed campus central plant. The estimated annual energy savings is nearly \$800,000 and the avoided greenhouse gas is over 4,000 metric tons per year.
- Installation of a solar heating system for the natatorium was completed in 2002.
- Installation of energy efficient HVAC equipment campus wide was completed in 2002. Investment was \$550,200 with a seven year payback.
- Initial campus wide lighting retrofit was completed in 2002.
- Provide information campus wide to all personnel on energy conservation measures.

New facilities incorporate energy efficient systems that consider:

- Orientation of structures
- Locations of windows.
- Protection of door openings with air locks.
- Selection and placement of vegetation to:
 - Capture maximum heat gain from the winter sun
 - Minimize heat buildup in the summer
- Use of window screens
- Seasonal climatic conditions

- Use of courts that:
 - Gather warmth from the morning sun
 - Protect occupants from the hot afternoon sun
 - Provide shelter from the bitter winter winds
 - Capture summer breezes

Status of CEQA Compliance

Antelope Valley College's recent capital outlay construction projects have been qualified as negative declarations or categorical exemptions to the College's Master Plan.

On September 7, 2005 the AVCCD 2020 Facilities Master Plan Update was filed with the County of Los Angeles and the California State Clearinghouse. The completed Environmental Impact Report was prepared as a comprehensive review of the Lancaster Campus based upon the 2003 Facilities Master Plan update pursuant to the provisions of the CEQA. All projects described in the Facilities Master Plan update for the EIR are covered by the State Clearinghouse Number 2005041020.

Inventory of Land

Antelope Valley CCD

Page 3

List the address and acreage of every land unit owned by the district (Education Code 81821(e)). Please identify all locations, both on-campus and off-campus, grouped according to their "parent" institution. In the event the list is long or complicated, please substitute copies of college bulletins or other notices to the public which display similar information. The list should be current as of October the prior year

Address	Acreage
Antelope Valley College 3041 West Avenue K Lancaster, CA. 93536	135.0

Legislative Districts

Campus	Assembly	Senate	House
Antelope Valley College	36	21	23
Palmdale Center	36	21	25

Instructional Delivery Locations

Antelope Valley CCD

Page 4

Address

Antelope Valley Health Care
44445 North 15th Street West
Lancaster, CA 93536

Antelope Valley Hospital
1600 West Avenue J
Lancaster, CA 93534

High Desert Medical Group
43839 15th Street West
Lancaster, CA 93534

Barns Aviation, Fox Field
50th Street West
Lancaster, CA 93536

Antelope Valley College
3041 West Avenue K
Lancaster, CA. 93536

American Medical Response
1055 West Avenue J
Lancaster, CA. 93534

Antelope Valley Lung Institute
1601 West Avenue J # 204
Lancaster, CA 93534

Child Care Resource Center
250 Grand Cypress Avenue
Palmdale, CA 93551

County Fire Department North Training Center
4110 6th Street West
Lancaster, CA 93534

Headstart
975 East Avenue P-8
Palmdale, CA 93550

Palmdale Corporate Plaza (Palmdale Center)
1529 East Palmdale Blvd.
Palmdale, CA 93550

Lancaster Adult Day Care
858 West Jackman, #101
Lancaster, CA 93534

Palmdale Regional Medical Center
38600 Medical Center Drive
Palmdale, CA 93551

Instructional Delivery Locations

Antelope Valley CCD

Address

Rosamond High School
2925 Rosamond Blvd.
Rosamond, CA 93536

Antelope Valley Community Clinic
45074 10th St. West, Suite 109
Lancaster, CA 93534

District Projects Priority Order

Antelope Valley CCD

No.	Project	Occupancy	Source	Schedule of Funds						
				2015/2016	2016/2017	2017/2018	2018/2019	2019/2020	2020/2021	2021/2022
1	Theatre Arts Facility									
0		2010/2011								
		\$11,276,000	State							
		\$14,734,000	NonState							
2	Health and Science Building									
		2012/2013								
		\$27,581,000	State							
		\$18,327,000	NonState							
3	Teaching and Learning Center									
63,788		2021/2022				(P)(W)	(C)(E)			
		\$78,426,000	State			\$5,149,000	\$73,277,000			
4	Gym Renovation & Expansion									
33,996		2022/2023					(P)(W)	(C)(E)		
		\$35,928,000	State				\$2,645,000	\$33,283,000		
5	Technical Building II									
3,388		2021/2022					(P)(W)	(C)(E)		
		\$11,952,000	State				\$955,000	\$10,997,000		
6	Off/On Site Development and Initial Fa									
27,505		2023/2024						(P)(W)	(C)(E)	
		\$20,417,000	State					\$1,222,000	\$19,195,000	
		\$14,650,000	NonState					\$1,194,000	\$13,456,000	
7	Student Services Building									
24,406		2022/2023						(P)(W)	(C)(E)	
		\$32,638,000	State					\$2,338,000	\$30,300,000	
8	Human Performance Center									
18,175		2022/2023						(P)(W)	(C)(E)	
		\$13,568,000	State					\$1,170,000	\$12,398,000	
9	Old Student Services Building #2 Repl									
15,095		2022/2023						(P)(W)	(C)(E)	
		\$17,192,000	State					\$1,338,000	\$15,854,000	
10	Learning Center Modernization									
10,720		2022/2023						(P)(W)	(C)(E)	
		\$5,996,000	State					\$594,000	\$5,402,000	
11	Arts Complex Replacement, Expansion									
30,157		2022/2023						(P)(W)	(C)(E)	
		\$36,772,000	State					\$2,626,000	\$34,146,000	
12	Student Center Expansion & Renovatio									
4,687		2023/2024							(P)(W)	(C)(E)
		\$25,483,000	NonState						\$2,124,000	\$23,359,000
13	New Instructional Building									
18,298		2023/2024							(P)(W)	(C)(E)
		\$17,807,000	State						\$1,324,000	\$16,483,000

District Lecture Capacity/Load Ratios

Antelope Valley CCD

No.	Project			2016/2017	2017/2018	2018/2019	2019/2020	2020/2021	2021/2022	2022/2023
3	Teaching and Learning Center 3,501 8,161 2021/2022 Antelope Valley College	Lect ASF	WSCH	Occupancy					120,643	105%
7	Student Services Building -738 -1,720 2022/2023 Antelope Valley College									118,923 102%
8	Human Performance Center 3,115 7,261 2022/2023 Antelope Valley College									126,184 108%
9	Old Student Services Building #2 Replacement 7,925 18,473 2022/2023 Antelope Valley College									144,657 124%
10	Learning Center Modernization 9,520 22,191 2022/2023 Antelope Valley College									166,848 143%
11	Arts Complex Replacement, Expansion 536 1,249 2022/2023 Antelope Valley College									168,098 144%
6	Off/On Site Development and Initial Facilities 1,309 3,051 2023/2024 Palmdale Center									

			2016/2017	2017/2018	2018/2019	2019/2020	2020/2021	2021/2022	2022/2023
Lecture	Actual*/Projected	WSCH	103,786	105,836	107,928	110,062	112,236	114,452	116,708
48,255	Cumulative Capacity		112,483	112,483	112,483	112,483	112,483	112,483	120,643
	Capacity/Load Ratio		108%	106%	104%	102%	100%	98%	103%

District Laboratory Capacity/Load Ratios

Antelope Valley CCD

No.	Project	2016/2017	2017/2018	2018/2019	2019/2020	2020/2021	2021/2022	2022/2023
3	Teaching and Learning Center 29,245 15,893 2021/2022 Antelope Valley College						71,562 97%	
5	Technical Building II 2,816 1,896 2021/2022 Antelope Valley College						73,458 100%	
7	Student Services Building 3,791 1,412 2022/2023 Antelope Valley College							74,870 100%
8	Human Performance Center 1,183 369 2022/2023 Antelope Valley College							75,239 100%
9	Old Student Services Building #2 Replacement -915 -356 2022/2023 Antelope Valley College							74,883 100%
11	Arts Complex Replacement, Expansion 25,499 9,922 2022/2023 Antelope Valley College							84,805 113%
6	Off/On Site Development and Initial Facilities 12,403 4,826 2023/2024 Palmdale Center							
13	New Instructional Building 11,380 7,409 2023/2024 Antelope Valley College							
15	Automotive Tech Completion 4,850 567 2025/2026 Antelope Valley College							

		2016/2017	2017/2018	2018/2019	2019/2020	2020/2021	2021/2022	2022/2023
Laboratory	Actual*/Projected WSCH	66,910	68,233	69,581	70,957	72,359	73,787	75,242
	147,447 Cumulative Capacity	55,669	55,669	55,669	55,669	55,669	55,669	73,458
	Capacity/Load Ratio	83%	82%	80%	78%	77%	75%	98%

District Office Capacity/Load Ratios

Antelope Valley CCD

No.	Project	Off ASF	FTE	Occupancy	2016/2017	2017/2018	2018/2019	2019/2020	2020/2021	2021/2022	2022/2023
13	New Instructional Building 6,318 45 2023/2024 Antelope Valley College										
14	Library Modernization 0 0 2024/2025 Antelope Valley College										
15	Automotive Tech Completion 200 1 2025/2026 Antelope Valley College										

		2016/2017	2017/2018	2018/2019	2019/2020	2020/2021	2021/2022	2022/2023
Office	Actual*/Projected FTE	424	431	439	447	455	463	471
57,725	Cumulative Capacity	412	412	412	412	412	412	449
	Capacity/Load Ratio	97%	96%	94%	92%	91%	89%	95%

District Library Capacity/Load Ratios

Antelope Valley CCD

No.	Project	Lib ASF	Occupancy	2016/2017	2017/2018	2018/2019	2019/2020	2020/2021	2021/2022	2022/2023
3	Teaching and Learning Center Antelope Valley College	25,405	2021/2022						52,509 97%	
6	Off/On Site Development and Initial Facilities Palmdale Center	4,455	2023/2024							
14	Library Modernization Antelope Valley College	0	2024/2025							

		2016/2017	2017/2018	2018/2019	2019/2020	2020/2021	2021/2022	2022/2023
Library	Actual*/Projected ASF	50,327	51,065	51,818	52,585	53,367	54,167	54,978
27,104	Cumulative Capacity	27,104	27,104	27,104	27,104	27,104	27,104	52,509
	Capacity/Load Ratio	54%	53%	52%	52%	51%	50%	96%

District AV/TV Capacity/Load Ratios

Antelope Valley CCD

No.	Project	AVTV ASF	Occupancy	2016/2017	2017/2018	2018/2019	2019/2020	2020/2021	2021/2022	2022/2023
3	Teaching and Learning Center -89 Antelope Valley College		2021/2022						10,511 61%	
6	Off/On Site Development and Initial Facilities 1,200 Palmdale Center		2023/2024							
14	Library Modernization 0 Antelope Valley College		2024/2025							

		2016/2017	2017/2018	2018/2019	2019/2020	2020/2021	2021/2022	2022/2023
AV/TV	Actual*/Projected ASF	16,928	16,990	17,054	17,120	17,186	17,254	17,323
10,600	Cumulative Capacity	10,600	10,600	10,600	10,600	10,600	10,600	10,511
	Capacity/Load Ratio	63%	62%	62%	62%	62%	61%	61%

Load Distribution and Staff Forecast

Antelope Valley CCD

Page 14

District Load Distribution

Reference: Chancellor's Office Forecast

	Instructional Staff FTE	Total Campus WSCH	Off-Campus WSCH	On-Campus WSCH	P.E. Laboratory WSCH	On-Campus Lecture WSCH	On-Campus Laboratory WSCH
Actual Fall							
2013	404	164,780	2,221	162,559	4,143	108,053	50,363
2014	397	168,036	1,878	166,158	2,240	121,053	42,864
Forecast							
2015	416	171,351	1,594	169,758	2,366	101,777	65,614
2016	424	174,734	1,625	173,109	2,413	103,786	66,910
2017	431	178,187	1,657	176,530	2,461	105,836	68,233
2018	439	181,709	1,690	180,019	2,509	107,928	69,581
2019	447	185,301	1,723	183,578	2,559	110,062	70,957
2020	455	188,962	1,757	187,205	2,610	112,236	72,359
2021	463	192,692	1,792	190,900	2,661	114,452	73,787

Load Distribution and Staff Forecast

Antelope Valley CCD

Instructional Load by Campus or Location

Reference: Chancellor's Office Forecast

WSCH Distributed to Campuses or Other Locations

Campus	Actual			Projected						
	2012	2013	2014	2015	2016	2017	2018	2019	2020	2021
Antelope Valley College	141,799	147,077	155,983	159,350	162,503	165,714	168,989	172,330	175,735	179,204
Palmdale Center	17,626	17,703	12,053	12,001	12,231	12,473	12,720	12,971	13,227	13,488
Total	<u>159,425</u>	<u>164,780</u>	<u>168,036</u>	<u>171,351</u>	<u>174,734</u>	<u>178,187</u>	<u>181,709</u>	<u>185,301</u>	<u>188,962</u>	<u>192,692</u>

Load Distribution and Staff Forecast

Antelope Valley CCD

Total District Library Load

Reference: Chancellor's Office Forecast of Day-Graded Enrollment

(a)	Total Day-Graded (b)	Number of Campuses (c)	Initial ASF (3,795/Camp) (d)	First 3,000 Day Graded (3.83/DG) (e)	Between 3k - 9k (3.39/DG) (f)	Above 9,000 (2.94/DG) (g)	Total ASF (d+e+f+g)
2015/2016	12,463	2	7,590	11,490	20,340	10,181	49,601
2016/2017	12,710	2	7,590	11,490	20,340	10,907	50,327
2017/2018	12,961	2	7,590	11,490	20,340	11,645	51,065
2018/2019	13,217	2	7,590	11,490	20,340	12,398	51,818
2019/2020	13,478	2	7,590	11,490	20,340	13,165	52,585
2020/2021	13,744	2	7,590	11,490	20,340	13,947	53,367
2021/2022	14,016	2	7,590	11,490	20,340	14,747	54,167

Load Distribution and Staff Forecast

Antelope Valley CCD

Library Load by Campus or Location

Reference: Chancellor's Office Forecast of Day-Graded Enrollment

Campus	2015	2016	2017	2018	2019	2020	2021
Antelope Valley College	46,129 (93%)	46,804 (93%)	47,491 (93%)	48,191 (93%)	48,904 (93%)	49,632 (93%)	50,375 (93%)
Palmdale Center	3,472 (7%)	3,523 (7%)	3,575 (7%)	3,627 (7%)	3,681 (7%)	3,736 (7%)	3,792 (7%)
Total	<u>49,601</u>	<u>50,327</u>	<u>51,065</u>	<u>51,818</u>	<u>52,585</u>	<u>53,367</u>	<u>54,167</u>

Load Distribution and Staff Forecast

Antelope Valley CCD

Total District AV, Radio, TV Load

Reference: Chancellor's Office Forecast of Day-Graded Enrollment

(a)	Total Day-Graded (b)	Number of Campuses (c)	Initial ASF (3,500/Camp) (d)	First 3,000 Day Graded (1.50/DG) (e)	Between 3k - 9k (0.75/DG) (f)	Above 9,000 (0.25/DG) (g)	Total ASF (d+e+f+g)
2015/2016	12,463	2	7,000	4,500	4,500	866	16,866
2016/2017	12,710	2	7,000	4,500	4,500	928	16,928
2017/2018	12,961	2	7,000	4,500	4,500	990	16,990
2018/2019	13,217	2	7,000	4,500	4,500	1,054	17,054
2019/2020	13,478	2	7,000	4,500	4,500	1,120	17,120
2020/2021	13,744	2	7,000	4,500	4,500	1,186	17,186
2021/2022	14,016	2	7,000	4,500	4,500	1,254	17,254

Load Distribution and Staff Forecast

Antelope Valley CCD

Page 19

AV, Radio, TV Load by Campus or Location

Reference: Chancellor's Office Forecast of Day-Graded Enrollment

Campus	2015	2016	2017	2018	2019	2020	2021
Antelope Valley College	15,685 (93%)	15,743 (93%)	15,801 (93%)	15,860 (93%)	15,921 (93%)	15,983 (93%)	16,046 (93%)
Palmdale Center	1,181 (7%)	1,185 (7%)	1,189 (7%)	1,194 (7%)	1,198 (7%)	1,203 (7%)	1,208 (7%)
Total	<u>16,866</u>	<u>16,928</u>	<u>16,990</u>	<u>17,054</u>	<u>17,120</u>	<u>17,186</u>	<u>17,254</u>

35th Street West

M

A



ANTELOPE VALLEY COLLEGE
 3041 West Avenue K
 Lancaster, California 93536-5426
 (661) 722-6300
 www.avc.edu



OFF-CAMPUS SITES:

- FOX Fox Field
- HOSP Various hospital clinic sites
- OFFSITE Various off-site locations
- PALMDL Palmdale Center
1529 E. Palmdale Blvd.
3rd floor
- SDBOWL Sands Bowl



LEGEND

- A** Administration Building
- APL** Applied Arts, Allied Health, & Offices
- BBS** Baseball Stadium
- BE** Business Education, IMC, & Offices
- CDC** Child Development Center
- CSUB** CSU Bakersfield—Antelope Valley
- FA1** Fine Arts [Art & Gallery]
- FA2** Fine Arts [Black Box]
- FA3** Fine Arts [Music & Offices]
- FA4** Fine Arts
- FS** Facilities Services
- GH1-4** Greenhouses
- GYM** Gymnasium [PE & Offices]
- HS** Health & Sciences
- HS001** Health & Sciences Greenhouse
- L** Library
- LC** Learning Center
- LH** Lecture Halls
- LS1** Liberal Studies & Offices
- LS2** Liberal Studies
- ME** Math/Engineering
- MS1-2** Marauder Stadium
- MS3** Stadium Ticket Booth
- MS4** Stadium Concessions/Restrooms
- NCP** North Central Plant
- OF1** Offices: Math/Science
- OF2** Offices: PE
- OF3** Offices: Language Arts & Social Science
- PA** Performing Arts Theatre Building
- RW** Receiving/Warehouse
- SA** SOAR High School Administration
- S1-9** SOAR High School
- SBS** Softball Stadium
- SCP** South Central Plant
- SCT** Student Center [Bookstore, Cafeteria, Security, Lost & Found]
- SS1** SOAR HS Restrooms
- SS1** Electrical Substation
- SSV** Student Services & Information
- T100** Assessment/Office for Students with Disabilities
- T501** Faculty Offices
- T502** Nursing Science
- T503-4** Sheriff's Academy
- T800** Construction Office
- T850** Field House—Home
- T851** Field House—Visitors
- TE1** Technical Ed.—Electronics
- TE2** Tech.Ed.—Welding/Fire Technology
- TE3** Tech.Ed.—Agriculture Lab
- TE4** Equipment Building
- TE6** Technical Ed.—Automotive
- TE7** Technical Ed.—Technology
- TE8** Technical Ed.—Auto Body

Antelope Valley CCD Report 17 Certification

Certification of Inventory for Fiscal Year: 2014-15

Campus Name: **Antelope Valley College**
Certified ASF: **423,275**
Certified OGSF: **671,138**

District Approval

Authorized Signature

Date

Printed Name

State Approval

Authorized Signature

Date

Included:

(2) Signed Copies of Report 17 Certification Sheet if the submission was not certified and submitted electronically by the CBO.

RECEIVED
OCT 14 2014
CALIFORNIA STATE BOARD OF EDUCATION
SCHOOL FINANCE UNIT

Campus Lecture Capacity/Load Ratios

Antelope Valley College

No.	Project			2016/2017	2017/2018	2018/2019	2019/2020	2020/2021	2021/2022	2022/2023
3	Teaching and Learning Center Lect ASF WSCH Occupancy 3,501 8,161 2021/2022 Antelope Valley College								106,911 102%	
7	Student Services Building -738 -1,720 2022/2023 Antelope Valley College									105,191 99%
8	Human Performance Center 3,115 7,261 2022/2023 Antelope Valley College									112,452 105%
9	Old Student Services Building #2 Replacement 7,925 18,473 2022/2023 Antelope Valley College									130,925 123%
10	Learning Center Modernization 9,520 22,191 2022/2023 Antelope Valley College									153,117 143%
11	Arts Complex Replacement, Expansion 536 1,249 2022/2023 Antelope Valley College									154,366 145%

		2016/2017	2017/2018	2018/2019	2019/2020	2020/2021	2021/2022	2022/2023
Lecture	Actual*/Projected WSCH	94,918	96,793	98,707	100,658	102,647	104,673	106,736
42,364	Cumulative Capacity	98,751	98,751	98,751	98,751	98,751	98,751	106,911
	Capacity/Load Ratio	104%	102%	100%	98%	96%	94%	100%

Campus Laboratory Capacity/Load Ratios

Antelope Valley College

No.	Project	2016/2017	2017/2018	2018/2019	2019/2020	2020/2021	2021/2022	2022/2023
3	Teaching and Learning Center 29,245 15,893 2021/2022 Antelope Valley College						71,330 102%	
5	Technical Building II 2,816 1,896 2021/2022 Antelope Valley College						73,226 104%	
7	Student Services Building 3,791 1,412 2022/2023 Antelope Valley College							74,638 104%
8	Human Performance Center 1,183 369 2022/2023 Antelope Valley College							75,007 105%
9	Old Student Services Building #2 Replacement -915 -356 2022/2023 Antelope Valley College							74,651 104%
11	Arts Complex Replacement, Expansion 25,499 9,922 2022/2023 Antelope Valley College							84,572 118%
13	New Instructional Building 11,380 7,409 2023/2024 Antelope Valley College							
15	Automotive Tech Completion 4,850 567 2025/2026 Antelope Valley College							

		2016/2017	2017/2018	2018/2019	2019/2020	2020/2021	2021/2022	2022/2023
Laboratory	Actual*/Projected WSCH	63,547	64,802	66,083	67,390	68,721	70,078	71,459
146,850	Cumulative Capacity	55,437	55,437	55,437	55,437	55,437	55,437	73,226
	Capacity/Load Ratio	87%	86%	84%	82%	81%	79%	102%

Campus Office Capacity/Load Ratios

Antelope Valley College

No.	Project	Off ASF	FTE	Occupancy	2016/2017	2017/2018	2018/2019	2019/2020	2020/2021	2021/2022	2022/2023
-----	---------	---------	-----	-----------	-----------	-----------	-----------	-----------	-----------	-----------	-----------

14 Library Modernization
 0 0 2024/2025
 Antelope Valley College

15 Automotive Tech Completion
 200 1 2025/2026
 Antelope Valley College

		2016/2017	2017/2018	2018/2019	2019/2020	2020/2021	2021/2022	2022/2023
Office	Actual*/Projected FTE	385	391	398	406	413	420	428
56,563	Cumulative Capacity	404	404	404	404	404	404	440
	Capacity/Load Ratio	105%	103%	102%	100%	98%	96%	103%

Campus Library Capacity/Load Ratios

Antelope Valley College

No.	Project	Lib ASF	Occupancy	2016/2017	2017/2018	2018/2019	2019/2020	2020/2021	2021/2022	2022/2023
3	Teaching and Learning Center Antelope Valley College	25,405	2021/2022						51,964 103%	
14	Library Modernization Antelope Valley College	0	2024/2025							

		2016/2017	2017/2018	2018/2019	2019/2020	2020/2021	2021/2022	2022/2023
Library	Actual*/Projected ASF	46,804	47,491	48,191	48,904	49,632	50,375	51,130
26,559	Cumulative Capacity	26,559	26,559	26,559	26,559	26,559	26,559	51,964
	Capacity/Load Ratio	57%	56%	55%	54%	54%	53%	102%

Campus AV/TV Capacity/Load Ratios

Antelope Valley College

No.	Project	AVTV ASF	Occupancy	2016/2017	2017/2018	2018/2019	2019/2020	2020/2021	2021/2022	2022/2023
-----	---------	----------	-----------	-----------	-----------	-----------	-----------	-----------	-----------	-----------

3	Teaching and Learning Center	-89	2021/2022						10,511	
	Antelope Valley College								66%	

14	Library Modernization	0	2024/2025							
	Antelope Valley College									

		2016/2017	2017/2018	2018/2019	2019/2020	2020/2021	2021/2022	2022/2023
AV/TV	Actual*/Projected ASF	15,743	15,801	15,860	15,921	15,983	16,046	16,110
10,600	Cumulative Capacity	10,600	10,600	10,600	10,600	10,600	10,600	10,511
	Capacity/Load Ratio	67%	67%	67%	67%	66%	66%	65%

Load Distribution and Staff Forecast

Antelope Valley College

Campus Load Distribution

Reference: Chancellor's Office Forecast

	Instructional Staff FTE	Total Campus WSCH	Off-Campus WSCH	On-Campus WSCH	P.E. Laboratory WSCH	On-Campus Lecture WSCH	On-Campus Laboratory WSCH
Actual Fall							
2013	348	147,077	2,221	144,856	4,143	95,243	45,470
2014	361	155,983	1,497	154,486	2,240	110,411	41,835
Forecast							
2015	378	159,350	1,594	157,757	2,366	93,076	62,314
2016	385	162,503	1,625	160,878	2,413	94,918	63,547
2017	391	165,714	1,657	164,057	2,461	96,793	64,802
2018	398	168,989	1,690	167,299	2,509	98,707	66,083
2019	406	172,330	1,723	170,607	2,559	100,658	67,390
2020	413	175,735	1,757	173,977	2,610	102,647	68,721
2021	420	179,204	1,792	177,412	2,661	104,673	70,078

Load Distribution and Staff Forecast

Antelope Valley College

Campus Worksheet for Computing FTE Instruction Staff

College Instructional Staff, Fall Term. Included are all certificated staff for day, extended day, and adult education except those whose office is located off-campus.

(a)	Total Certificated Instructional and Statutory Staff FTE (b)	Non-Instructional Portion of FTE (c)	Net Total Instructional and Statutory Staff FTE (b-c) (d)
Instructors	341.2		341.2
Counselors Include certificated special program coordinators, economic opportunity program, coordinators, statutory and Title 5 required staff, et. al.	17.0		17.0
Department Administrators	20.0		20.0
Librarians Include certificated director of audio/visual, et. al.	10.0	10.0	
Institutional Administrators Include certificated persons with responsibilities covering the entire institution, such as Superintendent, Assistant Superintendent, President, Dean of Instruction, Director of Data Processing, et. al.	9.0	9.0	
Fall 2015 Totals	397.2	19.0	378.2

Column (b) is the total number of Column (a) distributed to categories

Column (c) is the fraction of time express as Full-Time Equivalents devoted to noninstructional work.

Counselors, department administrators, and statutorily required staff are counted as if they had no noninstructional duties.

Load Distribution and Staff Forecast

Antelope Valley College

Campus Worksheet for Computing FTE Instruction Staff

College Instructional Staff, Fall Term. Included are all certificated staff for day, extended day, and adult education except those whose office is located off-campus.

(a)	Total Certificated Instructional and Statutory Staff FTE (b)	Non-Instructional Portion of FTE (c)	Net Total Instructional and Statutory Staff FTE (b-c) (d)
Instructors	348.0		348.0
Counselors Include certificated special program coordinators, economic opportunity program, coordinators, statutory and Title 5 required staff, et. al.	17.0		17.0
Department Administrators	20.0		20.0
Librarians Include certificated director of audio/visual, et. al.	10.0	10.0	
Institutional Administrators Include certificated persons with responsibilities covering the entire institution, such as Superintendent, Assistant Superintendent, President, Dean of Instruction, Director of Data Processing, et. al.	9.0	9.0	
Fall 2016 Totals	404.0	19.0	385.0

Column (b) is the total number of Column (a) distributed to categories

Column (c) is the fraction of time express as Full-Time Equivalents devoted to noninstructional work.

Counselors, department administrators, and statutorily required staff are counted as if they had no noninstructional duties.

Load Distribution and Staff Forecast

Antelope Valley College

Campus Worksheet for Computing FTE Instruction Staff

College Instructional Staff, Fall Term. Included are all certificated staff for day, extended day, and adult education except those whose office is located off-campus.

(a)	Total Certificated Instructional and Statutory Staff FTE (b)	Non-Instructional Portion of FTE (c)	Net Total Instructional and Statutory Staff FTE (b-c) (d)
Instructors	354.8		354.8
Counselors Include certificated special program coordinators, economic opportunity program, coordinators, statutory and Title 5 required staff, et. al.	17.0		17.0
Department Administrators	20.0		20.0
Librarians Include certificated director of audio/visual, et. al.	10.0	10.0	
Institutional Administrators Include certificated persons with responsibilities covering the entire institution, such as Superintendent, Assistant Superintendent, President, Dean of Instruction, Director of Data Processing, et. al.	9.0	9.0	
Fall 2017 Totals	410.8	19.0	391.8

Column (b) is the total number of Column (a) distributed to categories

Column (c) is the fraction of time express as Full-Time Equivalents devoted to noninstructional work.

Counselors, department administrators, and statutorily required staff are counted as if they had no noninstructional duties.

Load Distribution and Staff Forecast

Antelope Valley College

Campus Worksheet for Computing FTE Instruction Staff

College Instructional Staff, Fall Term. Included are all certificated staff for day, extended day, and adult education except those whose office is located off-campus.

(a)	Total Certificated Instructional and Statutory Staff FTE (b)	Non-Instructional Portion of FTE (c)	Net Total Instructional and Statutory Staff FTE (b-c) (d)
Instructors	361.8		361.8
Counselors Include certificated special program coordinators, economic opportunity program, coordinators, statutory and Title 5 required staff, et. al.	17.0		17.0
Department Administrators	20.0		20.0
Librarians Include certificated director of audio/visual, et. al.	10.0	10.0	
Institutional Administrators Include certificated persons with responsibilities covering the entire institution, such as Superintendent, Assistant Superintendent, President, Dean of Instruction, Director of Data Processing, et. al.	9.0	9.0	
Fall 2018 Totals	417.8	19.0	398.8

Column (b) is the total number of Column (a) distributed to categories

Column (c) is the fraction of time express as Full-Time Equivalents devoted to noninstructional work.

Counselors, department administrators, and statutorily required staff are counted as if they had no noninstructional duties.

Load Distribution and Staff Forecast

Antelope Valley College

Campus Worksheet for Computing FTE Instruction Staff

College Instructional Staff, Fall Term. Included are all certificated staff for day, extended day, and adult education except those whose office is located off-campus.

(a)	Total Certificated Instructional and Statutory Staff FTE (b)	Non-Instructional Portion of FTE (c)	Net Total Instructional and Statutory Staff FTE (b-c) (d)
Instructors	369.0		369.0
Counselors Include certificated special program coordinators, economic opportunity program, coordinators, statutory and Title 5 required staff, et. al.	17.0		17.0
Department Administrators	20.0		20.0
Librarians Include certificated director of audio/visual, et. al.	10.0	10.0	
Institutional Administrators Include certificated persons with responsibilities covering the entire institution, such as Superintendent, Assistant Superintendent, President, Dean of Instruction, Director of Data Processing, et. al.	9.0	9.0	
Fall 2019 Totals	425.0	19.0	406.0

Column (b) is the total number of Column (a) distributed to categories

Column (c) is the fraction of time express as Full-Time Equivalents devoted to noninstructional work.

Counselors, department administrators, and statutorily required staff are counted as if they had no noninstructional duties.

Load Distribution and Staff Forecast

Antelope Valley College

Campus Worksheet for Computing FTE Instruction Staff

College Instructional Staff, Fall Term. Included are all certificated staff for day, extended day, and adult education except those whose office is located off-campus.

(a)	Total Certificated Instructional and Statutory Staff FTE (b)	Non-Instructional Portion of FTE (c)	Net Total Instructional and Statutory Staff FTE (b-c) (d)
Instructors	376.2		376.2
Counselors Include certificated special program coordinators, economic opportunity program, coordinators, statutory and Title 5 required staff, et. al.	17.0		17.0
Department Administrators	20.0		20.0
Librarians Include certificated director of audio/visual, et. al.	10.0	10.0	
Institutional Administrators Include certificated persons with responsibilities covering the entire institution, such as Superintendent, Assistant Superintendent, President, Dean of Instruction, Director of Data Processing, et. al.	9.0	9.0	
Fall 2020 Totals	432.2	19.0	413.2

Column (b) is the total number of Column (a) distributed to categories

Column (c) is the fraction of time express as Full-Time Equivalents devoted to noninstructional work.

Counselors, department administrators, and statutorily required staff are counted as if they had no noninstructional duties.

Load Distribution and Staff Forecast

Antelope Valley College

Campus Worksheet for Computing FTE Instruction Staff

College Instructional Staff, Fall Term. Included are all certificated staff for day, extended day, and adult education except those whose office is located off-campus.

(a)	Total Certificated Instructional and Statutory Staff FTE (b)	Non-Instructional Portion of FTE (c)	Net Total Instructional and Statutory Staff FTE (b-c) (d)
Instructors	383.7		383.7
Counselors Include certificated special program coordinators, economic opportunity program, coordinators, statutory and Title 5 required staff, et. al.	17.0		17.0
Department Administrators	20.0		20.0
Librarians Include certificated director of audio/visual, et. al.	10.0	10.0	
Institutional Administrators Include certificated persons with responsibilities covering the entire institution, such as Superintendent, Assistant Superintendent, President, Dean of Instruction, Director of Data Processing, et. al.	9.0	9.0	
Fall 2021 Totals	439.7	19.0	420.7

Column (b) is the total number of Column (a) distributed to categories

Column (c) is the fraction of time express as Full-Time Equivalents devoted to noninstructional work.

Counselors, department administrators, and statutorily required staff are counted as if they had no noninstructional duties.

Cum Sum of Existing and Proposed Space, 2016 - 2022

Antelope Valley College

Cumulative Summary of Existing and Proposed Areas, 2016-2022

Priority and Year of Occupancy (a)	Classroom 100's (b)	Laboratory 200's (c)	Office 300's (d)	Library 400's (e)	AV Radio TV 530 - 535 (f)	P.E. 520 - 525 (g)	Assembly 610 - 625 (h)	Inactive 050 - 070 (i)	All Other Areas (j)	Total ASF (k)
Total ASF	42,364	146,850	56,563	26,559	10,600	39,736	25,503		75,100	423,275
3 2021/2022 Teaching and Learning Center	3,501	29,245	4,516	25,405	-89				1,210	63,788
	45,865	176,095	61,079	51,964	10,511				76,310	487,063
5 2021/2022 Technical Building II		2,816	572							3,388
		178,911	61,651							490,451
Total Existing and Proposed Space	45,865	178,911	61,651	51,964	10,511	39,736	25,503		76,310	490,451

Capacity of Net Existing On-Campus ASF

Antelope Valley College

Classrooms, Classroom Service (Room Type 100's)

	Net ASF	ASF/100 WSCH	Capacity WSCH
Totals	42,364	42.9	98,751

Laboratories and Laboratory Service Areas (Room Types 210, 215, 220, 225, 230, 235, 255)

TOP Code/Description	Net ASF	ASF/100 WSCH	Capacity WSCH	TOP Code/Description	Net ASF	ASF/100 WSCH	Capacity WSCH
0100 Agriculture and Natural Resources	1,669	492	339	0956 Manufacturing and Industrial Technology	1,953	385	507
0116 Agricultural Power Equipment Technology		856		1000 Fine and Applied Arts	23,748	257	9,240
0200 Architecture and Related Technologies	4,546	257	1,769	1100 Foreign Language		150	
0300 Environmental Sciences and Technologies		235		1200 Health	18,612	214	8,697
0400 Biological Sciences	11,776	235	5,011	1300 Family and Consumer Sciences	2,846	257	1,107
0500 Business and Management	3,941	128	3,079	1400 Law		150	
0600 Media and Communications	3,315	214	1,549	1500 Humanities (Letters)		150	
0700 Information Technology	3,268	171	1,911	1600 Library Science		150	
0800 Education		321		1700 Mathematics	1,163	150	775
0900 Engineering & Industrial Technologies	6,234	321	1,942	1800 Military Studies		214	
0945 Industrial Systems Technology and Mainte	4,419	556	795	1900 Physical Sciences	16,348	257	6,361
0946 Environmental Control Technology (HVAC)		556		2000 Psychology		150	
0947 Diesel Technology		856		2100 Public and Protective Services	3,406	214	1,592
0948 Automotive Technology	16,025	856	1,872	2200 Social Sciences	4,244	150	2,829
0949 Automotive Collison Repair		856		3000 Commercial Services		214	
0950 Aeronautical and Aviation Technology	5,729	749	765	4900 Interdisciplinary Studies	13,608	257	5,295
0952 Construction Crafts Technology		749					
Totals					146,850		55,437
Campus Avg Lab ASF/100 WSCH						265	

Office and Office Service Areas (Room Type 300's)

	Net ASF	ASF per FTE	Capacity FTE
Totals	56,563	140	404

Project Intent And Scope

Antelope Valley College

District Priority : **1 Theatre Arts Facility**

Project Type : Site Acquisition New Construction Reconstruction
 Replacement Infrastructure Equipment

Total Estimated Costs : \$26,010,000

Anticipated Source(s) of Funds : State and Non-State

Type of construction :

Seismic Retrofit :

If Existing - Age :

If Existing - Condition :

Anticipated Time Schedule

	Land Acquisition	Preliminary Plans	Working Drawing	Construction	Equipment	Occupancy
Year		2006/2007	2006/2007	2007/2008	2007/2008	2010/2011
Estimated Cost		\$825,000	\$1,251,000	\$22,254,000	\$1,680,000	

Explain why this project is needed:

Currently, the College has only a small experimental theater designed as a lab. It accommodates only 75—inadequate for a student population expected to reach 20,000 when this project would be completed. This project will construct a new 19,568 ASF theater complex. Included with the 400-seat theater will be a lobby, coat room, ticket room, theater manager`s office, orchestra pit, substage trap space, scene shop, prop storage, green room, men`s and women`s dressing rooms with co-ed makeup room, plus sundry meeting rooms, offices, and storage. Above the theater will be control booths, catwalks, flyloft & grid, costume storage, lighting shop, and mechanical equipment/fan room. All aspects of the theater will be accessible to the disabled. The existing experimental theater will remain, in the adjacent Fine Arts Complex.

Project Intent And Scope

Antelope Valley College

District Priority No.: **1 Theatre Arts Facility**

Outline of Project Space - Buildings and Remodelings

	Classroom Type 100's	Laboratory 210 - 255	Office Type 300's	Library Type 400's	AV - TV 530 - 535	All Other	Total ASF
Project Primary							
Project Secondary							
Project Net ASF							0

Project Net Capacity

	Net ASF	ASF/100 WSCH	Capacity WSCH
Classrooms, Classroom Service (Room Type 100's)			
Classroom Totals	0	42.9	0

Laboratories and Laboratory Service Areas (Room Types 210, 215, 220, 225, 230, 235, 255)

Primary Effect				Secondary Effect			
TOP Code/Description	Net ASF	ASF/100 WSCH	Capacity WSCH	TOP Code/Description	Net ASF	ASF/100 WSCH	Capacity WSCH
Laboratory Totals					0		0

	Net ASF	ASF per FTE	Capacity FTE
Office and Office Service Areas (Room Type 300's)			
Office Totals	0	140	0.00

Project Intent And Scope

Antelope Valley College

District Priority : **2 Health and Science Building**

Project Type : Site Acquisition New Construction Reconstruction
 Replacement Infrastructure Equipment

Total Estimated Costs : \$45,908,000

Anticipated Source(s) of Funds : State and Non-State

Type of construction :

Seismic Retrofit :

If Existing - Age :

If Existing - Condition :

Anticipated Time Schedule

	Land Acquisition	Preliminary Plans	Working Drawing	Construction	Equipment	Occupancy
Year		2007/2008	2007/2008	2008/2009	2009/2010	2012/2013
Estimated Cost		\$1,604,000	\$2,128,000	\$40,108,000	\$2,068,000	

Explain why this project is needed:

This project will construct approximately 66,000 asf in a multi-story building to house the life and physical science and the Allied Health programs. The present science buildings on the Lancaster campus are more than 40 years old with inadequate wiring for computer/electronic technology. The buildings also present construction safety concerns that would be excessively expensive to reconstruct.

Project Intent And Scope

Antelope Valley College

District Priority No.: **2 Health and Science Building**

Outline of Project Space - Buildings and Remodelings

	Classroom Type 100's	Laboratory 210 - 255	Office Type 300's	Library Type 400's	AV - TV 530 - 535	All Other	Total ASF
Project Primary							
Project Secondary							
Project Net ASF							0

Project Net Capacity

	Net ASF	ASF/100 WSCH	Capacity WSCH
Classrooms, Classroom Service (Room Type 100's)			
Classroom Totals	0	42.9	0

Laboratories and Laboratory Service Areas (Room Types 210, 215, 220, 225, 230, 235, 255)

Primary Effect				Secondary Effect			
TOP Code/Description	Net ASF	ASF/100 WSCH	Capacity WSCH	TOP Code/Description	Net ASF	ASF/100 WSCH	Capacity WSCH
Laboratory Totals					0		0

	Net ASF	ASF per FTE	Capacity FTE
Office and Office Service Areas (Room Type 300's)			
Office Totals	0	140	0.00

Project Intent And Scope

Antelope Valley College

Page 41

District Priority : **3 Teaching and Learning Center**

Project Type : Site Acquisition New Construction Reconstruction
 Replacement Infrastructure Equipment

Total Estimated Costs : \$78,426,000

Anticipated Source(s) of Funds : State

Type of construction :

Seismic Retrofit :

If Existing - Age :

If Existing - Condition :

Anticipated Time Schedule

	Land Acquisition	Preliminary Plans	Working Drawing	Construction	Equipment	Occupancy
Year		2017/2018	2017/2018	2018/2019	2018/2019	2021/2022
Estimated Cost		\$2,915,000	\$2,234,000	\$66,944,000	\$6,333,000	

Explain why this project is needed:

PURPOSE - The project involves the construction of a new building to house instruction in a technology-rich learning environment, and to enhance student access to Basic Skills instruction.

FACILITIES PROBLEM – There is a lack of general lecture space and computer lab space for current programs that use instructional technology. Learning Skills programs are isolated from other instruction.

PROPOSAL - Create a facility to cluster functions including Computer Information Science, Deaf Studies and Interpreting, Engineering, Drafting, Math, Basic Skills and Learning Resources, and Distance Learning. These functions are presently dispersed in the Learning Center #9, Math - Engineering Building #10, Applied Arts Building #34, and Business Education Building #36.

Project Intent And Scope

Antelope Valley College

District Priority No.: **3 Teaching and Learning Center**

Outline of Project Space - Buildings and Remodelings

	Classroom Type 100's	Laboratory 210 - 255	Office Type 300's	Library Type 400's	AV - TV 530 - 535	All Other	Total ASF
Project Primary	9,914	41,388	7,360	28,757		1,850	89,269
Project Secondary	-6,413	-12,143	-2,844	-3,352	-89	-640	-25,481
Project Net ASF	3,501	29,245	4,516	25,405	-89	1,210	63,788

Project Net Capacity

	Net ASF	ASF/100 WSCH	Capacity WSCH
Classrooms, Classroom Service (Room Type 100's)			
Classroom Totals	3,501	42.9	8,161

Laboratories and Laboratory Service Areas (Room Types 210, 215, 220, 225, 230, 235, 255)

Primary Effect				Secondary Effect			
TOP Code/Description	Net ASF	ASF/100 WSCH	Capacity WSCH	TOP Code/Description	Net ASF	ASF/100 WSCH	Capacity WSCH
0800 Sign Language	1,928	321	601	0400 Biology, General	-222	235	-94
0900 Drafting Technology	6,900	321	2,150	0900 Drafting Technology	-1,406	321	-438
				1000 Photography	-552	257	-215
				1700 Mathematics	-1,163	150	-775
1700 Mathematics, General	19,530	150	13,020	1900 Geology	-1,008	257	-392
4900 General Studies	13,030	257	5,070	4900 Interdisciplinary Studies	-7,792	257	-3,032
				Laboratory Totals	29,245		15,893

	Net ASF	ASF per FTE	Capacity FTE
Office and Office Service Areas (Room Type 300's)			
Office Totals	4,516	140	32,26

Project Intent And Scope

Antelope Valley College

District Priority : **4 Gym Renovation & Expansion**

Project Type : Site Acquisition New Construction Reconstruction
 Replacement Infrastructure Equipment

Total Estimated Costs : \$35,928,000

Anticipated Source(s) of Funds : State

Type of construction :

Seismic Retrofit :

If Existing - Age :

If Existing - Condition :

Anticipated Time Schedule

	Land Acquisition	Preliminary Plans	Working Drawing	Construction	Equipment	Occupancy
Year		2018/2019	2018/2019	2019/2020	2019/2020	2022/2023
Estimated Cost		\$1,263,000	\$1,382,000	\$32,796,000	\$487,000	

Explain why this project is needed:

This project proposes to renovate and expand the existing Gymnasium in order to expand spaces to support the physical education programs. It will also renovate the existing pool area for adaptive physical education and physical education classes, and replace the existing natatorium.

The project will construct 1,493 asf in Office and 66,845 in Physical Education space.

Project Intent And Scope

Antelope Valley College

District Priority No.: **4 Gym Renovation & Expansion**

Outline of Project Space - Buildings and Remodelings

	Classroom Type 100's	Laboratory 210 - 255	Office Type 300's	Library Type 400's	AV - TV 530 - 535	All Other	Total ASF
Project Primary			1,493			66,845	68,338
Project Secondary			-1,014			-33,328	-34,342
Project Net ASF			479			33,517	33,996

Project Net Capacity

	Net ASF	ASF/100 WSCH	Capacity WSCH
Classrooms, Classroom Service (Room Type 100's)			
Classroom Totals	0	42.9	0

Laboratories and Laboratory Service Areas (Room Types 210, 215, 220, 225, 230, 235, 255)

Primary Effect				Secondary Effect			
TOP Code/Description	Net ASF	ASF/100 WSCH	Capacity WSCH	TOP Code/Description	Net ASF	ASF/100 WSCH	Capacity WSCH
Laboratory Totals					0		0

	Net ASF	ASF per FTE	Capacity FTE
Office and Office Service Areas (Room Type 300's)			
Office Totals	479	140	3.42

Project Intent And Scope

Antelope Valley College

District Priority : **5 Technical Building II**

Project Type : Site Acquisition New Construction Reconstruction
 Replacement Infrastructure Equipment

Total Estimated Costs : \$11,952,000

Anticipated Source(s) of Funds : State

Type of construction :

Seismic Retrofit :

If Existing - Age :

If Existing - Condition :

Anticipated Time Schedule

	Land Acquisition	Preliminary Plans	Working Drawing	Construction	Equipment	Occupancy
Year		2018/2019	2018/2019	2019/2020	2019/2020	2021/2022
Estimated Cost		\$464,000	\$491,000	\$10,102,000	\$895,000	

Explain why this project is needed:

The current Technical Ed 1 and Technical Ed 2 Buildings (#23 and 24) at the Antelope Valley campus were constructed in 1960 and have outlived their useful life. A comprehensive facilities analysis completed by the College, Architects, and Engineers indicates the existing facilities have severe deficiencies in the areas of structural integrity, building systems, accessibility, and efficiency. This is also supported by a Facilities Condition Index (FCI) of 82% for both structures.

The academic programs in the facilities continue to grow and are in need of more space in addition to modern teaching spaces.

This project proposes to construct a new building to house Engineering, Electronics, Welding and Fire Technology programs, in addition to some faculty offices that will support current and future needs of students. The new facility will consist of 14,130 asf in Lab and 900 asf in Office space.

Project Intent And Scope

Antelope Valley College

District Priority No.: **5 Technical Building II**

Outline of Project Space - Buildings and Remodelings

	Classroom Type 100's	Laboratory 210 - 255	Office Type 300's	Library Type 400's	AV - TV 530 - 535	All Other	Total ASF
Project Primary		14,130	900				15,030
Project Secondary		-11,314	-328				-11,642
Project Net ASF		2,816	572				3,388

Project Net Capacity

	Net ASF	ASF/100 WSCH	Capacity WSCH
Classrooms, Classroom Service (Room Type 100's)			
Classroom Totals	0	42.9	0

Laboratories and Laboratory Service Areas (Room Types 210, 215, 220, 225, 230, 235, 255)

Primary Effect				Secondary Effect			
TOP Code/Description	Net ASF	ASF/100 WSCH	Capacity WSCH	TOP Code/Description	Net ASF	ASF/100 WSCH	Capacity WSCH
0900 Electronics and Electric Technology	3,000	321	935	0900 Drafting Technology	-2,688	321	-837
0900 Engineering, General (requires Calculu	3,000	321	935				
0956 Manufacturing and Industrial Technolo	4,130	385	1,073	0948 Automotive Technology	-4,272	856	-499
				0956 Manufacturing and Industrial Technolo	-1,953	385	-507
				1000 Photography	-643	257	-250
2100 Fire Technology	4,000	214	1,869	2100 Fire Technology	-1,758	214	-821
				Laboratory Totals	2,816		1,896

	Net ASF	ASF per FTE	Capacity FTE
Office and Office Service Areas (Room Type 300's)			
Office Totals	572	140	4.09

Project Intent And Scope

Antelope Valley College

Page 47

District Priority : **7 Student Services Building**

Project Type : Site Acquisition New Construction Reconstruction
 Replacement Infrastructure Equipment

Total Estimated Costs : \$32,638,000

Anticipated Source(s) of Funds : State

Type of construction :

Seismic Retrofit :

If Existing - Age :

If Existing - Condition :

Anticipated Time Schedule

	Land Acquisition	Preliminary Plans	Working Drawing	Construction	Equipment	Occupancy
Year		2019/2020	2019/2020	2020/2021	2020/2021	2022/2023
Estimated Cost		\$1,115,000	\$1,223,000	\$28,214,000	\$2,086,000	

Explain why this project is needed:

The new Student Services Building will be located across from the current Administration Building at the southeast corner of the campus. By locating this building there, the result will be to concentrate all the administrative and student services close to each other with good visibility and parking access. The building will house the following student services: Admissions and Records, Counseling, Financial Aid, Counseling, Student Assessment, EOP&S/CARE, Disabled Student Services and Programs, Student Development, Career Center Job Placement Center, Deans of Student Services, Transfer Center, Veterans Services and the Cashier's Office.

Type of Project Space: New Construction - Lab = 6,910 ASF; Office = 35,721 ASF; Other = 3,715 ASF. Secondary spaces include vacating the current Student Services Building #2.

District Priority No.: **7 Student Services Building**

Outline of Project Space - Buildings and Remodelings

	Classroom Type 100's	Laboratory 210 - 255	Office Type 300's	Library Type 400's	AV - TV 530 - 535	All Other	Total ASF
Project Primary		6,910	35,721			3,715	46,346
Project Secondary	-738	-3,119	-15,023			-3,060	-21,940
Project Net ASF	-738	3,791	20,698			655	24,406

Project Net Capacity

Classrooms, Classroom Service (Room Type 100's)	Net ASF	ASF/100 WSCH	Capacity WSCH
Classroom Totals	-738	42.9	-1,720

Laboratories and Laboratory Service Areas (Room Types 210, 215, 220, 225, 230, 235, 255)

Primary Effect				Secondary Effect			
TOP Code/Description	Net ASF	ASF/100 WSCH	Capacity WSCH	TOP Code/Description	Net ASF	ASF/100 WSCH	Capacity WSCH
4900 General Studies	6,910	257	2,689	0700 Computer Software Development	-321	171	-188
				1900 Earth Science	-1,174	257	-457
				4900 General Studies	-1,624	257	-632
				Laboratory Totals	3,791		1,412

Office and Office Service Areas (Room Type 300's)	Net ASF	ASF per FTE	Capacity FTE
Office Totals	20,698	140	147.84

Project Intent And Scope

Antelope Valley College

Page 49

District Priority : **8 Human Performance Center**

Project Type : Site Acquisition New Construction Reconstruction
 Replacement Infrastructure Equipment

Total Estimated Costs : \$13,568,000

Anticipated Source(s) of Funds : State

Type of construction :

Seismic Retrofit :

If Existing - Age :

If Existing - Condition :

Anticipated Time Schedule

	Land Acquisition	Preliminary Plans	Working Drawing	Construction	Equipment	Occupancy
Year		2019/2020	2019/2020	2020/2021	2020/2021	2022/2023
Estimated Cost		\$616,000	\$554,000	\$12,115,000	\$283,000	

Explain why this project is needed:

PURPOSE - To expand instructional facilities to fully house the approved, for-credit curriculum for Physical Education programs, and to provide needed general instructional space at Antelope Valley College.

FACILITIES PROBLEM - Presently, classes overflow the existing facilities so that some PE students participate out of doors, or they encroach in rooms in use by other classes. Some classes in the approved curriculum are not currently offered because the existing space is fully scheduled. Physical Education faculty offices are housed in three locations on campus.

SCOPE - Construct a new facility to house instruction and consolidate faculty offices. Extend campus utility infrastructure to locate the facility as identified in the Facilities Master Plan. The new building will house classrooms, lab, fitness studios, offices, and service areas. Functions will be vacated from the modular Faculty Office Bldg. #21 and relocated to the new facility. The vacated modular will be removed.

Project Intent And Scope

Antelope Valley College

District Priority No.: **8 Human Performance Center**

Outline of Project Space - Buildings and Remodelings

	Classroom Type 100's	Laboratory 210 - 255	Office Type 300's	Library Type 400's	AV - TV 530 - 535	All Other	Total ASF
Project Primary	3,115	1,183	3,000			12,430	19,728
Project Secondary			-1,553				-1,553
Project Net ASF	3,115	1,183	1,447			12,430	18,175

Project Net Capacity

	Net ASF	ASF/100 WSCH	Capacity WSCH
Classrooms, Classroom Service (Room Type 100's)			
Classroom Totals	3,115	42.9	7,261

Laboratories and Laboratory Service Areas (Room Types 210, 215, 220, 225, 230, 235, 255)

Primary Effect				Secondary Effect			
TOP Code/Description	Net ASF	ASF/100 WSCH	Capacity WSCH	TOP Code/Description	Net ASF	ASF/100 WSCH	Capacity WSCH
0800 Recreation	1,183	321	369				
Laboratory Totals					1,183		369

	Net ASF	ASF per FTE	Capacity FTE
Office and Office Service Areas (Room Type 300's)			
Office Totals	1,447	140	10.34

Project Intent And Scope

Antelope Valley College

Page 51

District Priority : **9 Old Student Services Building #2 Replacement**

Project Type : Site Acquisition New Construction Reconstruction
 Replacement Infrastructure Equipment

Total Estimated Costs : \$17,192,000

Anticipated Source(s) of Funds : State

Type of construction :

Seismic Retrofit :

If Existing - Age :

If Existing - Condition :

Anticipated Time Schedule

	Land Acquisition	Preliminary Plans	Working Drawing	Construction	Equipment	Occupancy
Year		2019/2020	2019/2020	2020/2021	2020/2021	2022/2023
Estimated Cost		\$622,000	\$716,000	\$15,510,000	\$344,000	

Explain why this project is needed:**PURPOSE**

To replace aged and dysfunctional existing and then vacated space with modern facilities for instruction and for College administrative functions.

FACILITIES PROBLEM

The existing facility houses Student Services and general instruction. A large portion of the building will be vacated when functions are relocated to the new Student Services building. According to the third party evaluation, the existing building would require costly improvements to meet current codes for structural safety. There is a need to increase general instructional space on the campus. As the District grows, the District and College functions will become separate functions and the College will require its own space.

SCOPE OF WORK

Demolish the existing Student Services Building #2 and replace it with a facility to house general instruction and College administrative functions. Vacate academic programs from the Liberal Studies Language Building #20 and relocate them to the new replacement facility.

District Priority No.: **9 Old Student Services Building #2 Replacement**

Outline of Project Space - Buildings and Remodelings

	Classroom Type 100's	Laboratory 210 - 255	Office Type 300's	Library Type 400's	AV - TV 530 - 535	All Other	Total ASF
Project Primary	13,850		5,000			3,085	21,935
Project Secondary	-5,925	-915					-6,840
Project Net ASF	7,925	-915	5,000			3,085	15,095

Project Net Capacity

	Net ASF	ASF/100 WSCH	Capacity WSCH
Classrooms, Classroom Service (Room Type 100's)			
Classroom Totals	7,925	42.9	18,473

Laboratories and Laboratory Service Areas (Room Types 210, 215, 220, 225, 230, 235, 255)

Primary Effect				Secondary Effect			
TOP Code/Description	Net ASF	ASF/100 WSCH	Capacity WSCH	TOP Code/Description	Net ASF	ASF/100 WSCH	Capacity WSCH
				4900 Interdisciplinary Studies	-915	257	-356
				Laboratory Totals	-915		-356

	Net ASF	ASF per FTE	Capacity FTE
Office and Office Service Areas (Room Type 300's)			
Office Totals	5,000	140	35.71

Project Intent And Scope

Antelope Valley College

District Priority : **10 Learning Center Modernization**

Project Type : Site Acquisition New Construction Reconstruction
 Replacement Infrastructure Equipment

Total Estimated Costs : \$5,996,000

Anticipated Source(s) of Funds : State

Type of construction :

Seismic Retrofit :

If Existing - Age :

If Existing - Condition :

Anticipated Time Schedule

	Land Acquisition	Preliminary Plans	Working Drawing	Construction	Equipment	Occupancy
Year		2019/2020	2019/2020	2020/2021	2020/2021	2022/2023
Estimated Cost		\$276,000	\$318,000	\$5,231,000	\$171,000	

Explain why this project is needed:

When the functions are relocated from the existing Learning Center to the new Teaching and Learning Center, this space will be available for reuse. The Learning Center is in an ideal location for the expansion of space for the some components of the Language Arts Division, including Foreign Languages. These programs have been experiencing tremendous growth and need the appropriate facilities to expand their programs. These programs are not the Language Arts Basic Skills programs that are part of the Teaching and Learning Center project.

There is no secondary space in this project since the buildings space inventory was used as secondary space for the Teaching and Learning Center project.

Project Intent And Scope

Antelope Valley College

District Priority No.: **10 Learning Center Modernization**

Outline of Project Space - Buildings and Remodelings

	Classroom Type 100's	Laboratory 210 - 255	Office Type 300's	Library Type 400's	AV - TV 530 - 535	All Other	Total ASF
Project Primary	9,520		1,000			200	10,720
Project Secondary							
Project Net ASF	9,520		1,000			200	10,720

Project Net Capacity

	Net ASF	ASF/100 WSCH	Capacity WSCH
Classrooms, Classroom Service (Room Type 100's)			
Classroom Totals	9,520	42.9	22,191

Laboratories and Laboratory Service Areas (Room Types 210, 215, 220, 225, 230, 235, 255)

Primary Effect				Secondary Effect		
TOP Code/Description	Net ASF	ASF/100 WSCH	Capacity WSCH	TOP Code/Description	Net ASF	Capacity WSCH
Laboratory Totals					0	0

	Net ASF	ASF per FTE	Capacity FTE
Office and Office Service Areas (Room Type 300's)			
Office Totals	1,000	140	7.14

Project Intent And Scope

Antelope Valley College

District Priority : **11 Arts Complex Replacement, Expansion**

Project Type : Site Acquisition New Construction Reconstruction
 Replacement Infrastructure Equipment

Total Estimated Costs : \$36,772,000

Anticipated Source(s) of Funds : State

Type of construction :

Seismic Retrofit :

If Existing - Age :

If Existing - Condition :

Anticipated Time Schedule

	Land Acquisition	Preliminary Plans	Working Drawing	Construction	Equipment	Occupancy
Year		2019/2020	2019/2020	2020/2021	2020/2021	2022/2023
Estimated Cost		\$1,217,000	\$1,409,000	\$32,083,000	\$2,063,000	

Explain why this project is needed:**PURPOSE**

The purpose of the project is to consolidate existing Visual and Performing Arts programs in order to expand student access to related Arts instruction.

FACILITIES PROBLEMS

Presently, instruction is dispersed because it has outgrown the existing Arts Complex. Existing facilities are aged, dysfunctional and inadequate to support the current curriculum. Third party engineering reports describe structural improvements to the existing buildings that will be required to meet current codes.

PROPOSED PROJECT

The proposed project will renovate, replace and expand the existing Fine Arts 1 (Building #6), Fine Arts 3 (Building 8) and Fine Arts 4 (Building #9) to consolidate current programs in Visual Arts, Music and Dance, and to provide general instructional space

Project Intent And Scope

Antelope Valley College

District Priority No.: **11 Arts Complex Replacement, Expansion**

Outline of Project Space - Buildings and Remodelings

	Classroom Type 100's	Laboratory 210 - 255	Office Type 300's	Library Type 400's	AV - TV 530 - 535	All Other	Total ASF
Project Primary	1,600	36,150	4,200			2,700	44,650
Project Secondary	-1,064	-10,651	-1,358			-1,420	-14,493
Project Net ASF	536	25,499	2,842			1,280	30,157

Project Net Capacity

	Net ASF	ASF/100 WSCH	Capacity WSCH
Classrooms, Classroom Service (Room Type 100's)			
Classroom Totals	536	42.9	1,249

Laboratories and Laboratory Service Areas (Room Types 210, 215, 220, 225, 230, 235, 255)

Primary Effect				Secondary Effect			
TOP Code/Description	Net ASF	ASF/100 WSCH	Capacity WSCH	TOP Code/Description	Net ASF	ASF/100 WSCH	Capacity WSCH
1000 Art (Painting, Drawing and Sculpture)	12,500	257	4,864	1000 Art (Painting, Drawing and Sculpture)	-2,954	257	-1,149
1000 Commercial Music	3,000	257	1,167				
1000 Dance	7,100	257	2,763				
1000 Music	13,550	257	5,272	1000 Graphic Arts and Design	-746	257	-290
				1000 Music	-5,945	257	-2,313
				1300 Nutrition, Foods, and Culinary Arts	-1,006	257	-391
				Laboratory Totals	25,499		9,922

	Net ASF	ASF per FTE	Capacity FTE
Office and Office Service Areas (Room Type 300's)			
Office Totals	2,842	140	20.30

Project Intent And Scope

Antelope Valley College

District Priority : **12 Student Center Expansion & Renovation**

Project Type : Site Acquisition New Construction Reconstruction
 Replacement Infrastructure Equipment

Total Estimated Costs : \$25,483,000

Anticipated Source(s) of Funds : Non-State

Type of construction :

Seismic Retrofit :

If Existing - Age :

If Existing - Condition :

Anticipated Time Schedule

	Land Acquisition	Preliminary Plans	Working Drawing	Construction	Equipment	Occupancy
Year		2020/2021	2020/2021	2021/2022	2021/2022	2023/2024
Estimated Cost		\$978,000	\$1,146,000	\$22,161,000	\$1,198,000	

Explain why this project is needed:

The existing Student Center will be renovated and expanded (by 20%) to house the Cafeteria, Bookstore, Student Lounge, Student Activities and Campus Security.

Project Intent And Scope

Antelope Valley College

District Priority No.: **12 Student Center Expansion & Renovation**

Outline of Project Space - Buildings and Remodelings

	Classroom Type 100's	Laboratory 210 - 255	Office Type 300's	Library Type 400's	AV - TV 530 - 535	All Other	Total ASF
Project Primary			680			27,440	28,120
Project Secondary			-567			-22,866	-23,433
Project Net ASF			113			4,574	4,687

Project Net Capacity

	Net ASF	ASF/100 WSCH	Capacity WSCH
Classrooms, Classroom Service (Room Type 100's)			
Classroom Totals	0	42.9	0

Laboratories and Laboratory Service Areas (Room Types 210, 215, 220, 225, 230, 235, 255)

Primary Effect				Secondary Effect			
TOP Code/Description	Net ASF	ASF/100 WSCH	Capacity WSCH	TOP Code/Description	Net ASF	ASF/100 WSCH	Capacity WSCH
				Laboratory Totals	0		0

	Net ASF	ASF per FTE	Capacity FTE
Office and Office Service Areas (Room Type 300's)			
Office Totals	113	140	0.81

Project Intent And Scope

Antelope Valley College

District Priority : **13 New Instructional Building**

Project Type : Site Acquisition New Construction Reconstruction
 Replacement Infrastructure Equipment

Total Estimated Costs : \$17,807,000

Anticipated Source(s) of Funds : State

Type of construction :

Seismic Retrofit :

If Existing - Age :

If Existing - Condition :

Anticipated Time Schedule

	Land Acquisition	Preliminary Plans	Working Drawing	Construction	Equipment	Occupancy
Year		2020/2021	2020/2021	2021/2022	2021/2022	2023/2024
Estimated Cost		\$671,000	\$653,000	\$15,937,000	\$546,000	

Explain why this project is needed:

The new facility will house the Language Arts Division and the Social and Behavioral Sciences Division. It will contain labs, faculty offices and support spaces.

The existing building 17 will be removed.

Project Intent And Scope

Antelope Valley College

District Priority No.: **13 New Instructional Building**

Outline of Project Space - Buildings and Remodelings

	Classroom Type 100's	Laboratory 210 - 255	Office Type 300's	Library Type 400's	AV - TV 530 - 535	All Other	Total ASF
Project Primary		11,380	9,300			600	21,280
Project Secondary			-2,982				-2,982
Project Net ASF		11,380	6,318			600	18,298

Project Net Capacity

Classrooms, Classroom Service (Room Type 100's)	Net ASF	ASF/100 WSCH	Capacity WSCH
Classroom Totals	0	42.9	0

Laboratories and Laboratory Service Areas (Room Types 210, 215, 220, 225, 230, 235, 255)

Primary Effect				Secondary Effect			
TOP Code/Description	Net ASF	ASF/100 WSCH	Capacity WSCH	TOP Code/Description	Net ASF	ASF/100 WSCH	Capacity WSCH
0800 Education	500	321	156				
1500 Humanities (Letters)	4,580	150	3,053				
2000 Psychology	2,150	150	1,433				
2200 Social Sciences	4,150	150	2,767				
				Laboratory Totals	11,380		7,409

Office and Office Service Areas (Room Type 300's)	Net ASF	ASF per FTE	Capacity FTE
Office Totals	6,318	140	45.13

Project Intent And Scope

Antelope Valley College

District Priority : **14 Library Modernization**

Project Type : Site Acquisition New Construction Reconstruction
 Replacement Infrastructure Equipment

Total Estimated Costs : \$13,160,000

Anticipated Source(s) of Funds : State

Type of construction :

Seismic Retrofit :

If Existing - Age :

If Existing - Condition :

Anticipated Time Schedule

	Land Acquisition	Preliminary Plans	Working Drawing	Construction	Equipment	Occupancy
Year		2021/2022	2021/2022	2022/2023	2022/2023	2024/2025
Estimated Cost		\$587,000	\$583,000	\$11,990,000	\$0	

Explain why this project is needed:

Reorganize space in the existing Library to improve efficiency. The entire building will be modernized.

Project Intent And Scope

Antelope Valley College

District Priority No.: **14 Library Modernization**

Outline of Project Space - Buildings and Remodelings

	Classroom Type 100's	Laboratory 210 - 255	Office Type 300's	Library Type 400's	AV - TV 530 - 535	All Other	Total ASF
Project Primary			990	23,207	3,266		27,463
Project Secondary			-990	-23,207	-3,266		-27,463
Project Net ASF							0

Project Net Capacity

	Net ASF	ASF/100 WSCH	Capacity WSCH
Classrooms, Classroom Service (Room Type 100's)			
Classroom Totals	0	42.9	0

Laboratories and Laboratory Service Areas (Room Types 210, 215, 220, 225, 230, 235, 255)

Primary Effect				Secondary Effect			
TOP Code/Description	Net ASF	ASF/100 WSCH	Capacity WSCH	TOP Code/Description	Net ASF	ASF/100 WSCH	Capacity WSCH
Laboratory Totals					0		0

	Net ASF	ASF per FTE	Capacity FTE
Office and Office Service Areas (Room Type 300's)			
Office Totals	0	140	0.00

Project Intent And Scope

Antelope Valley College

District Priority : **15 Automotive Tech Completion**

Project Type : Site Acquisition New Construction Reconstruction
 Replacement Infrastructure Equipment

Total Estimated Costs : \$3,955,000

Anticipated Source(s) of Funds : State

Type of construction :

Seismic Retrofit :

If Existing - Age :

If Existing - Condition :

Anticipated Time Schedule

	Land Acquisition	Preliminary Plans	Working Drawing	Construction	Equipment	Occupancy
Year		2022/2023	2022/2023	2023/2024	2023/2024	2025/2026
Estimated Cost		\$194,000	\$209,000	\$3,205,000	\$347,000	

Explain why this project is needed:

Expand facilities to support growth in Automotive Technology programs.

Project Intent And Scope

Antelope Valley College

District Priority No.: **15 Automotive Tech Completion**

Outline of Project Space - Buildings and Remodelings

	Classroom Type 100's	Laboratory 210 - 255	Office Type 300's	Library Type 400's	AV - TV 530 - 535	All Other	Total ASF
Project Primary		4,850	200				5,050
Project Secondary							
Project Net ASF		4,850	200				5,050

Project Net Capacity

Classrooms, Classroom Service (Room Type 100's)	Net ASF	ASF/100 WSCH	Capacity WSCH
Classroom Totals	0	42.9	0

Laboratories and Laboratory Service Areas (Room Types 210, 215, 220, 225, 230, 235, 255)

Primary Effect				Secondary Effect			
TOP Code/Description	Net ASF	ASF/100 WSCH	Capacity WSCH	TOP Code/Description	Net ASF	ASF/100 WSCH	Capacity WSCH
0948 Automotive Technology	4,850	856	567				
Laboratory Totals					4,850		567

Office and Office Service Areas (Room Type 300's)	Net ASF	ASF per FTE	Capacity FTE
Office Totals	200	140	1.43

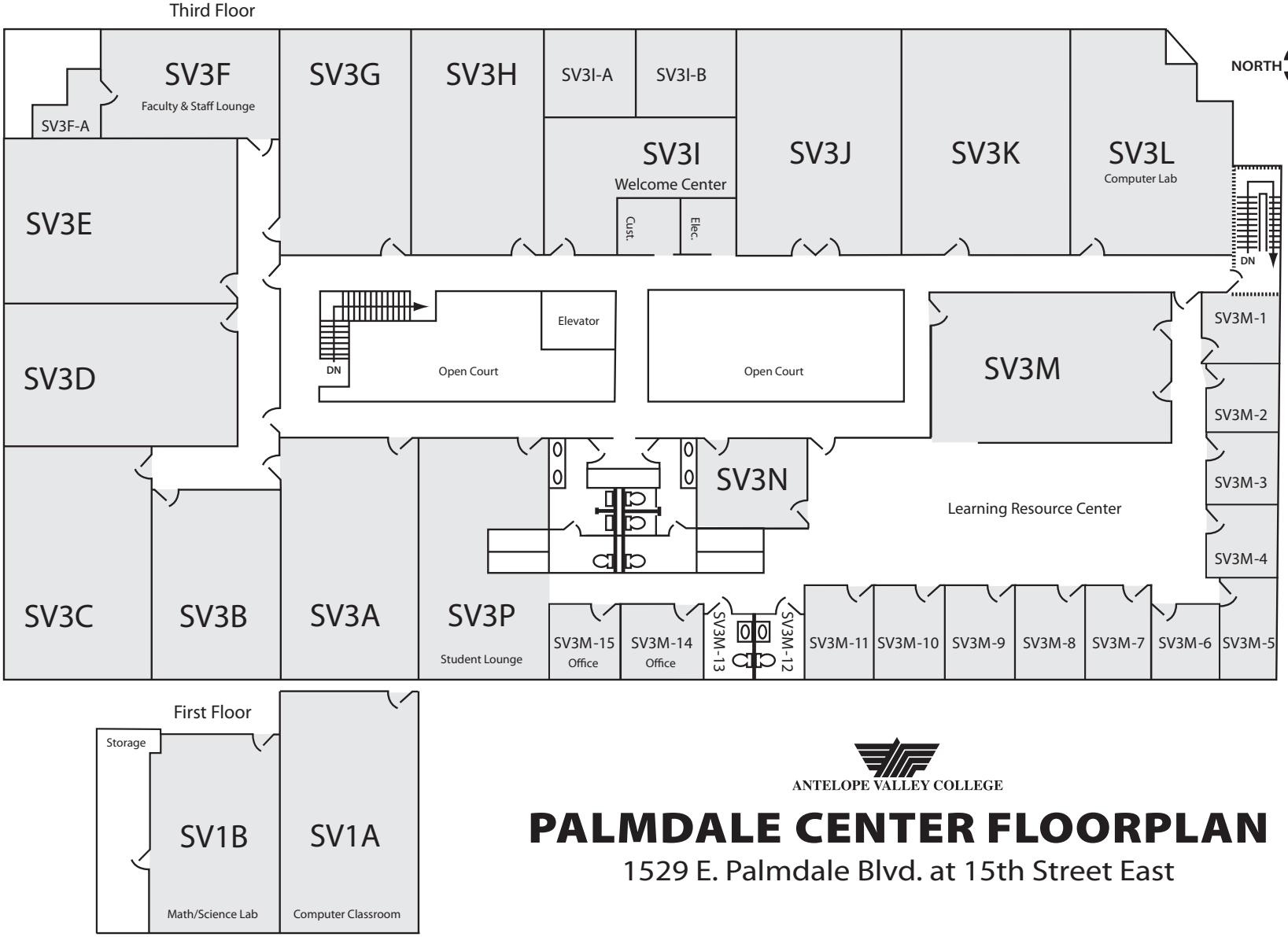

PALMDALE CENTER FLOORPLAN

1529 E. Palmdale Blvd. at 15th Street East

Antelope Valley CCD Report 17 Certification

Certification of Inventory for Fiscal Year: 2014-15

Campus Name: **Palmdale Center**
Certified ASF: **8,195**
Certified OGSF: **11,812**

District Approval



Authorized Signature



Date



Printed Name

State Approval



Authorized Signature



Date

Included:

(2) Signed Copies of Report 17 Certification Sheet if the submission was not certified and submitted electronically by the CBO.

RECEIVED
OCT 21 2014
CA COMMUNITY COLLEGE SYSTEM
COLLEGE PARK, CALIFORNIA

Campus Lecture Capacity/Load Ratios

Palmdale Center

No.	Project			2016/2017	2017/2018	2018/2019	2019/2020	2020/2021	2021/2022	2022/2023
	Lect ASF	WSCH	Occupancy							

6 Off/On Site Development and Initial Facilities
 1,309 2,767 2023/2024
 Palmdale Center

		2016/2017	2017/2018	2018/2019	2019/2020	2020/2021	2021/2022	2022/2023
Lecture	Actual*/Projected WSCH	8,868	9,043	9,222	9,404	9,590	9,779	9,972
5,891	Cumulative Capacity	12,455	12,455	12,455	12,455	12,455	12,455	12,455
	Capacity/Load Ratio	140%	138%	135%	132%	130%	127%	125%

Campus Laboratory Capacity/Load Ratios

Palmdale Center

No.	Project			2016/2017	2017/2018	2018/2019	2019/2020	2020/2021	2021/2022	2022/2023
	Lab ASF	WSCH	Occupancy							

6 Off/On Site Development and Initial Facilities
 12,403 4,826 2023/2024
 Palmdale Center

		2016/2017	2017/2018	2018/2019	2019/2020	2020/2021	2021/2022	2022/2023
Laboratory	Actual*/Projected WSCH	3,364	3,430	3,498	3,567	3,638	3,709	3,782
597	Cumulative Capacity	232	232	232	232	232	232	232
	Capacity/Load Ratio	7%	7%	7%	7%	6%	6%	6%

Campus Office Capacity/Load Ratios

Palmdale Center

No.	Project			2016/2017	2017/2018	2018/2019	2019/2020	2020/2021	2021/2022	2022/2023
	Off ASF	FTE	Occupancy							

6 Off/On Site Development and Initial Facilities
 6,138 38 2023/2024
 Palmdale Center

		2016/2017	2017/2018	2018/2019	2019/2020	2020/2021	2021/2022	2022/2023
Office	Actual*/Projected FTE	39	40	41	41	42	43	43
1,162	Cumulative Capacity	7	7	7	7	7	7	7
	Capacity/Load Ratio	19%	18%	18%	18%	17%	17%	17%

Campus Library Capacity/Load Ratios

Palmdale Center

No.	Project	Lib ASF	Occupancy	2016/2017	2017/2018	2018/2019	2019/2020	2020/2021	2021/2022	2022/2023
-----	---------	---------	-----------	-----------	-----------	-----------	-----------	-----------	-----------	-----------

6 Off/On Site Development and Initial Facilities

4,455 2023/2024

Palmdale Center

		2016/2017	2017/2018	2018/2019	2019/2020	2020/2021	2021/2022	2022/2023
Library	Actual*/Projected ASF	3,523	3,575	3,627	3,681	3,736	3,792	3,848
545	Cumulative Capacity	545	545	545	545	545	545	545
	Capacity/Load Ratio	15%	15%	15%	15%	15%	14%	14%

Campus AV/TV Capacity/Load Ratios

Palmdale Center

No.	Project	AVTV ASF	Occupancy	2016/2017	2017/2018	2018/2019	2019/2020	2020/2021	2021/2022	2022/2023
-----	---------	-------------	-----------	-----------	-----------	-----------	-----------	-----------	-----------	-----------

6 Off/On Site Development and Initial Facilities
 1,200 2023/2024
 Palmdale Center

		2016/2017	2017/2018	2018/2019	2019/2020	2020/2021	2021/2022	2022/2023
AV/TV	Actual*/Projected ASF	1,185	1,189	1,194	1,198	1,203	1,208	1,213
0	Cumulative Capacity	0	0	0	0	0	0	0
	Capacity/Load Ratio	0%	0%	0%	0%	0%	0%	0%

Load Distribution and Staff Forecast

Palmdale Center

Page 71

Campus Load Distribution

Reference: Chancellor's Office Forecast

	Instructional Staff FTE	Total Campus WSCH	Off-Campus WSCH	On-Campus WSCH	P.E. Laboratory WSCH	On-Campus Lecture WSCH	On-Campus Laboratory WSCH
Actual Fall							
2013	56	17,703	0	17,703	0	12,810	4,893
2014	36	12,053	381	11,672	0	10,643	1,029
Forecast							
2015	38	12,001	0	12,001	0	8,701	3,300
2016	39	12,231	0	12,231	0	8,868	3,364
2017	40	12,473	0	12,473	0	9,043	3,430
2018	41	12,720	0	12,720	0	9,222	3,498
2019	41	12,971	0	12,971	0	9,404	3,567
2020	42	13,227	0	13,227	0	9,590	3,638
2021	43	13,488	0	13,488	0	9,779	3,709

Load Distribution and Staff Forecast

Palmdale Center

Campus Worksheet for Computing FTE Instruction Staff

College Instructional Staff, Fall Term. Included are all certificated staff for day, extended day, and adult education except those whose office is located off-campus.

(a)	Total Certificated Instructional and Statutory Staff FTE (b)	Non-Instructional Portion of FTE (c)	Net Total Instructional and Statutory Staff FTE (b-c) (d)
Instructors	34.0		34.0
Counselors Include certificated special program coordinators, economic opportunity program, coordinators, statutory and Title 5 required staff, et. al.	3.0		3.0
Department Administrators	1.0		1.0
Librarians Include certificated director of audio/visual, et. al.	2.0	2.0	
Institutional Administrators Include certificated persons with responsibilities covering the entire institution, such as Superintendent, Assistant Superintendent, President, Dean of Instruction, Director of Data Processing, et. al.	1.0	1.0	
Fall 2015 Totals	41.0	3.0	38.0

Column (b) is the total number of Column (a) distributed to categories

Column (c) is the fraction of time express as Full-Time Equivalents devoted to noninstructional work.

Counselors, department administrators, and statutorily required staff are counted as if they had no noninstructional duties.

Load Distribution and Staff Forecast

Palmdale Center

Campus Worksheet for Computing FTE Instruction Staff

College Instructional Staff, Fall Term. Included are all certificated staff for day, extended day, and adult education except those whose office is located off-campus.

(a)	Total Certificated Instructional and Statutory Staff FTE (b)	Non-Instructional Portion of FTE (c)	Net Total Instructional and Statutory Staff FTE (b-c) (d)
Instructors	34.6		34.6
Counselors Include certificated special program coordinators, economic opportunity program, coordinators, statutory and Title 5 required staff, et. al.	3.0		3.0
Department Administrators	2.0		2.0
Librarians Include certificated director of audio/visual, et. al.	2.0	2.0	
Institutional Administrators Include certificated persons with responsibilities covering the entire institution, such as Superintendent, Assistant Superintendent, President, Dean of Instruction, Director of Data Processing, et. al.	2.0	2.0	
Fall 2016 Totals	43.6	4.0	39.6

Column (b) is the total number of Column (a) distributed to categories

Column (c) is the fraction of time express as Full-Time Equivalents devoted to noninstructional work.

Counselors, department administrators, and statutorily required staff are counted as if they had no noninstructional duties.

Load Distribution and Staff Forecast

Palmdale Center

Page 74

Campus Worksheet for Computing FTE Instruction Staff

College Instructional Staff, Fall Term. Included are all certificated staff for day, extended day, and adult education except those whose office is located off-campus.

(a)	Total Certificated Instructional and Statutory Staff FTE (b)	Non-Instructional Portion of FTE (c)	Net Total Instructional and Statutory Staff FTE (b-c) (d)
Instructors	35.3		35.3
Counselors Include certificated special program coordinators, economic opportunity program, coordinators, statutory and Title 5 required staff, et. al.	3.0		3.0
Department Administrators	2.0		2.0
Librarians Include certificated director of audio/visual, et. al.	2.0	2.0	
Institutional Administrators Include certificated persons with responsibilities covering the entire institution, such as Superintendent, Assistant Superintendent, President, Dean of Instruction, Director of Data Processing, et. al.	2.0	2.0	
Fall 2017 Totals	44.3	4.0	40.3

Column (b) is the total number of Column (a) distributed to categories

Column (c) is the fraction of time express as Full-Time Equivalents devoted to noninstructional work.

Counselors, department administrators, and statutorily required staff are counted as if they had no noninstructional duties.

Load Distribution and Staff Forecast

Palmdale Center

Campus Worksheet for Computing FTE Instruction Staff

College Instructional Staff, Fall Term. Included are all certificated staff for day, extended day, and adult education except those whose office is located off-campus.

(a)	Total Certificated Instructional and Statutory Staff FTE (b)	Non-Instructional Portion of FTE (c)	Net Total Instructional and Statutory Staff FTE (b-c) (d)
Instructors	36.0		36.0
Counselors Include certificated special program coordinators, economic opportunity program, coordinators, statutory and Title 5 required staff, et. al.	3.0		3.0
Department Administrators	2.0		2.0
Librarians Include certificated director of audio/visual, et. al.	2.0	2.0	
Institutional Administrators Include certificated persons with responsibilities covering the entire institution, such as Superintendent, Assistant Superintendent, President, Dean of Instruction, Director of Data Processing, et. al.	2.0	2.0	
Fall 2018 Totals	45.0	4.0	41.0

Column (b) is the total number of Column (a) distributed to categories

Column (c) is the fraction of time express as Full-Time Equivalents devoted to noninstructional work.

Counselors, department administrators, and statutorily required staff are counted as if they had no noninstructional duties.

Load Distribution and Staff Forecast

Palmdale Center

Campus Worksheet for Computing FTE Instruction Staff

College Instructional Staff, Fall Term. Included are all certificated staff for day, extended day, and adult education except those whose office is located off-campus.

(a)	Total Certificated Instructional and Statutory Staff FTE (b)	Non-Instructional Portion of FTE (c)	Net Total Instructional and Statutory Staff FTE (b-c) (d)
Instructors	36.7		36.7
Counselors Include certificated special program coordinators, economic opportunity program, coordinators, statutory and Title 5 required staff, et. al.	3.0		3.0
Department Administrators	2.0		2.0
Librarians Include certificated director of audio/visual, et. al.	2.0	2.0	
Institutional Administrators Include certificated persons with responsibilities covering the entire institution, such as Superintendent, Assistant Superintendent, President, Dean of Instruction, Director of Data Processing, et. al.	2.0	2.0	
Fall 2019 Totals	45.7	4.0	41.7

Column (b) is the total number of Column (a) distributed to categories

Column (c) is the fraction of time express as Full-Time Equivalents devoted to noninstructional work.

Counselors, department administrators, and statutorily required staff are counted as if they had no noninstructional duties.

Load Distribution and Staff Forecast

Palmdale Center

Page 77

Campus Worksheet for Computing FTE Instruction Staff

College Instructional Staff, Fall Term. Included are all certificated staff for day, extended day, and adult education except those whose office is located off-campus.

(a)	Total Certificated Instructional and Statutory Staff FTE (b)	Non-Instructional Portion of FTE (c)	Net Total Instructional and Statutory Staff FTE (b-c) (d)
Instructors	37.4		37.4
Counselors Include certificated special program coordinators, economic opportunity program, coordinators, statutory and Title 5 required staff, et. al.	3.0		3.0
Department Administrators	2.0		2.0
Librarians Include certificated director of audio/visual, et. al.	2.0	2.0	
Institutional Administrators Include certificated persons with responsibilities covering the entire institution, such as Superintendent, Assistant Superintendent, President, Dean of Instruction, Director of Data Processing, et. al.	2.0	2.0	
Fall 2020 Totals	46.4	4.0	42.4

Column (b) is the total number of Column (a) distributed to categories

Column (c) is the fraction of time express as Full-Time Equivalents devoted to noninstructional work.

Counselors, department administrators, and statutorily required staff are counted as if they had no noninstructional duties.

Load Distribution and Staff Forecast

Palmdale Center

Campus Worksheet for Computing FTE Instruction Staff

College Instructional Staff, Fall Term. Included are all certificated staff for day, extended day, and adult education except those whose office is located off-campus.

(a)	Total Certificated Instructional and Statutory Staff FTE (b)	Non-Instructional Portion of FTE (c)	Net Total Instructional and Statutory Staff FTE (b-c) (d)
Instructors	38.1		38.1
Counselors Include certificated special program coordinators, economic opportunity program, coordinators, statutory and Title 5 required staff, et. al.	3.0		3.0
Department Administrators	2.0		2.0
Librarians Include certificated director of audio/visual, et. al.	2.0	2.0	
Institutional Administrators Include certificated persons with responsibilities covering the entire institution, such as Superintendent, Assistant Superintendent, President, Dean of Instruction, Director of Data Processing, et. al.	2.0	2.0	
Fall 2021 Totals	47.1	4.0	43.1

Column (b) is the total number of Column (a) distributed to categories

Column (c) is the fraction of time express as Full-Time Equivalents devoted to noninstructional work.

Counselors, department administrators, and statutorily required staff are counted as if they had no noninstructional duties.

Cum Sum of Existing and Proposed Space, 2016 - 2022

Palmdale Center

Cumulative Summary of Existing and Proposed Areas, 2016-2022

Priority and Year of Occupancy (a)	Classroom 100's (b)	Laboratory 200's (c)	Office 300's (d)	Library 400's (e)	AV Radio TV 530 - 535 (f)	P.E. 520 - 525 (g)	Assembly 610 - 625 (h)	Inactive 050 - 070 (i)	All Other Areas (j)	Total ASF (k)
Total ASF	5,891	597	1,162	545						8,195

Capacity of Net Existing On-Campus ASF

Palmdale Center

Classrooms, Classroom Service (Room Type 100's)

	Net ASF	ASF/100 WSCH	Capacity WSCH
Totals	5,891	47.3	12,455

Laboratories and Laboratory Service Areas (Room Types 210, 215, 220, 225, 230, 235, 255)

TOP Code/Description	Net ASF	ASF/100 WSCH	Capacity WSCH	TOP Code/Description	Net ASF	ASF/100 WSCH	Capacity WSCH
0100 Agriculture and Natural Resources		492		0956 Manufacturing and Industrial Technology		385	
0116 Agricultural Power Equipment Technology		856		1000 Fine and Applied Arts		257	
0200 Architecture and Related Technologies		257		1100 Foreign Language		150	
0300 Environmental Sciences and Technologies		235		1200 Health		214	
0400 Biological Sciences		235		1300 Family and Consumer Sciences		257	
0500 Business and Management		128		1400 Law		150	
0600 Media and Communications		214		1500 Humanities (Letters)		150	
0700 Information Technology		171		1600 Library Science		150	
0800 Education		321		1700 Mathematics		150	
0900 Engineering & Industrial Technologies		321		1800 Military Studies		214	
0945 Industrial Systems Technology and Mainte		556		1900 Physical Sciences		257	
0946 Environmental Control Technology (HVAC)		556		2000 Psychology		150	
0947 Diesel Technology		856		2100 Public and Protective Services		214	
0948 Automotive Technology		856		2200 Social Sciences		150	
0949 Automotive Collison Repair		856		3000 Commercial Services		214	
0950 Aeronautical and Aviation Technology		749		4900 Interdisciplinary Studies	597	257	232
0952 Construction Crafts Technology		749					
				Totals	597		232
				Campus Avg Lab ASF/100 WSCH		257	

Office and Office Service Areas (Room Type 300's)

	Net ASF	ASF per FTE	Capacity FTE
Totals	1,162	160	7

Project Intent And Scope

Palmdale Center

District Priority : **6 Off/On Site Development and Initial Facilities**

Project Type : Site Acquisition New Construction Reconstruction
 Replacement Infrastructure Equipment

Total Estimated Costs : \$35,067,000

Anticipated Source(s) of Funds : State and Non-State

Type of construction :

Seismic Retrofit :

If Existing - Age :

If Existing - Condition :

Anticipated Time Schedule

	Land Acquisition	Preliminary Plans	Working Drawing	Construction	Equipment	Occupancy
Year		2019/2020	2019/2020	2020/2021	2020/2021	2023/2024
Estimated Cost		\$1,174,000	\$1,242,000	\$29,239,000	\$3,412,000	

Explain why this project is needed:

This project establishes the first phase of the Palmdale Center at its permanent location. This phase will include both on and off-site development necessary to allow access and provide utilities for the Center including roads, parking, storm drains, sewer, water, fire hydrants, gas and electricity. This phase also constructs a total of 35,700 assignable square feet of instructional space including 7,200 asf of lecture space, 13,000 asf of interdisciplinary labs, 7,300 asf in offices and student service spaces, 5,000 asf of library, a 1,200 asf distance education classroom and 2,000 asf of meeting rooms. Once this project is complete, the Palmdale leased facility will be vacated.

Project Intent And Scope

Palmdale Center

District Priority No.: **6 Off/On Site Development and Initial Facilities**

Outline of Project Space - Buildings and Remodelings

	Classroom Type 100's	Laboratory 210 - 255	Office Type 300's	Library Type 400's	AV - TV 530 - 535	All Other	Total ASF
Project Primary	7,200	13,000	7,300	5,000	1,200	2,000	35,700
Project Secondary	-5,891	-597	-1,162	-545			-8,195
Project Net ASF	1,309	12,403	6,138	4,455	1,200	2,000	27,505

Project Net Capacity

	Net ASF	ASF/100 WSCH	Capacity WSCH
Classrooms, Classroom Service (Room Type 100's)			
Classroom Totals	1,309	47.3	2,767

Laboratories and Laboratory Service Areas (Room Types 210, 215, 220, 225, 230, 235, 255)

Primary Effect				Secondary Effect			
TOP Code/Description	Net ASF	ASF/100 WSCH	Capacity WSCH	TOP Code/Description	Net ASF	ASF/100 WSCH	Capacity WSCH
4900 Interdisciplinary Studies	13,000	257	5,058	4900 Interdisciplinary Studies	-597	257	-232
Laboratory Totals					12,403		4,826

	Net ASF	ASF per FTE	Capacity FTE
Office and Office Service Areas (Room Type 300's)			
Office Totals	6,138	160	38